



Vehicle Service

Contents

04 |



Cordless IQ^V™ Tools and Accessories

Impact Tools & Ratchets
Drills & Drivers
Grinder/Polisher
Other tools
Batteries and Chargers

18 |



Air Impacttools™

1/4" and 3/8"
1/2"
3/4"
1" (pistol and rear handle)
Accessories

44 |



DXS | Drive Xchange System Accessories

DXS Anvil
DXS Socket

48 |



Air Ratchets

1/4"
3/8"
1/2"

52 |



Air Grinders

Die Grinders
Wheel Grinders

58 |



Air Finishing Tools

Air Sanders and Polishers
Belt Sander & Engraving Pen
& Pencil Grinder
Pads, Disks and Bonnets

68 |



Air Hammers

Air Hammer
Needle Scaler

72 |



Air Drills, Screwdrivers and Specialty tools

Drills
Screwdrivers
Specialty Air Tools



The new **IQ^V series** are power tools how you want them – As powerful as air tools, with the convenience of cordless.



Cordless IQ^V™ Tools and Accessories

- 06 | Impact Tools & Ratchets
- 12 | Drills & Drivers
- 13 | Grinder/Polisher
- 14 | Other tools
- 15 | Batteries and Chargers

Peter Mayrhofer isn't one to compromise between comfort and performance. He wants it all in one compact tool. The new IQ^V™ line lets him have it his way: The cordless Impacttools™ can remove even the toughest bolts. They deliver all the power he needs, with the handling and accessibility he expects.

Peter Mayrhofer, Inzell

Cordless IQ^V™ Tools and Accessories



W7153-AP

DXS System - IQV20

Std. Anvil 1/2"

Other Interchangeable Anvils Available:

3/8", 1/2", and 3/4" drive options and five lengths from 2" to 10" (Sold Separately)

Full Range of Sockets Available:

DXS® Sockets in Metric (Sold Separately)

- 1356 Nm of maximum forward torque and 2033 Nm of nut-busting torque
- IQV Power Control System with 4 modes
- Adjustable 360° Shadowless LED Light
- DXS Drive Xchange System



More Information about DXS System, See Page 44



Available in kits

Part Number

W7153-K22B-AN

W7153-K22-JP

W7153-K22-KR

W7153-K22-SGHK

Impact Tool, Charger 12/20 V, 2 BL2022 (5.0 Ah) Li-Ion Batteries & Carry Case

Part Number	Battery	V	in	Tighten/Breakaway Nm	rpm	bpm	kg	mm	dB(A)	m/s ² /K
W7153-AP	BL2022	IQV20	Std 1/2" w. / DXS	1,356/2,033	1,900	2,450	2.76	211	95.0	17.0/3.7

Cordless IQV™ Tools and Accessories | Impact Tools and Ratchets

W3111

1/4"  Quick Change Hex - IQV20



- 384 Nm of Forward Torque
- 474 Nm of breakaway Torque
- 360° Shadowless Light
- 3 Output Modes
- Compact & Light Weight design
- Brushless Motor & Variable speed Trigger



Available in kits

Part Number

W3111-K22-AP1

W3111-K22-JP

W3111-K22-KR

1/4" QC Hex Impact Driver, Charger 12/20 V, 2 BL2012 (2.5 Ah) Li-Ion Batteries

W3131

3/8"  Square Anvil – IQV20



- 406 Nm of Forward Torque
- 542 Nm of breakaway Torque
- 360° Shadowless Light
- 3 Output Modes
- Compact & Light Weight design
- Brushless Motor & Variable speed Trigger



Available in kits

Part Number

W3131-K22-AP1

W3131-K22-JP

W3131-K22-KR

3/8" Impact Wrench, Charger 12/20 V, 2 BL2022 (5.0 Ah) Li-Ion Batteries

W3151

1/2"  Square Anvil – IQV20



- 433 Nm of Forward Torque
- 610 Nm of breakaway Torque
- 360° Shadowless Light
- 3 Output Modes
- Compact & Light Weight design
- Brushless Motor & Variable speed Trigger



Available in kits



Part Number

W3151-K22-AP1

W3151-K22-JP

W3151-K22-KR

1/2" Impact Wrench, Charger 12/20 V, 2 BL2022 (5.0 Ah) Li-Ion Batteries

Part Number	Battery	V	in	Tighten/Breakaway Nm	rpm	bpm	kg	mm	dB(A)	m/s ² /K
W3111	BL2012	IQV20	1/4" 	384/474	2,800	4,200	1.0	132	90	18.1/5.8
W3131	BL2022	IQV20	3/8" 	406/542	2,800	4,200	1.0	132	90	18.1/5.8
W3151	BL2022	IQV20	1/2" 	433/610	2,800	4,200	1.0	135	90	18.1/5.8

Cordless IQV™ Tools and Accessories | Impact Tools and Ratchets

W5133

3/8" ■ Anvil – IQV20



- 495 Nm of Forward Torque
745 Nm of Breakaway Torque
- Steel-reinforced chemical-resistant housings add strength for unmatched drop resistance
- Adjustable 360° Shadowless LED Light
- IQV Power Control System with 4 modes and Auto Shut-Off
- Powerful Brushless Motor and variable speed Trigger

Available in kits

Part Number

W5133-K22-AUNZ

W5133-K22-JP

W5133-K22-KR

W5133-K22-SGHK

3/8" Anvil Impact Driver, Charger, 1 BL2012 (2.5 Ah) and 1 BL2022 (5.0 Ah) Li-Ion Batteries

W5153

1/2" ■ Anvil – IQV20



- 495 Nm of Forward Torque
745 Nm of Breakaway Torque
- Steel-reinforced chemical-resistant housings add strength for unmatched drop resistance
- Adjustable 360° Shadowless LED Light
- IQV Power Control System with 4 modes and Auto Shut-Off
- Powerful Brushless Motor and variable speed Trigger

Available in kits

Part Number

W5153-K22-AUNZ

W5153-K22-JP

W5153-K22-KR

W5153-K22-SGHK

1/2" Anvil Impact Driver, Charger, 1 BL2012 (2.5 Ah) and 1 BL2022 (5.0 Ah) Li-Ion Batteries

W5133P-C1D2/W5153P-C1D2

1/2" ■ Pin Anvil - IQV20



- 495 Nm of Forward Torque
745 Nm of Breakaway Torque
- Steel-reinforced chemical-resistant housings add strength for unmatched drop resistance
- Adjustable 360° Shadowless LED Light
- IQV Power Control System with 4 modes and Auto Shut-Off
- Powerful Brushless Motor and variable speed Trigger
- Certified Class 1, Division 2 cordless impact made specifically for hazardous environments in oil & Gas, petrochemical, heavy equipment and mining, with a T4 temperature classification

Available in kits

Part Number

W5133P-C1D2-K22

W5153P-C1D2-K22

1/2" Anvil C1D2 Impact Driver, Charger, 1 BL2012 (2.5 Ah) and 1 BL2022 (5.0 Ah) Li-Ion Batteries

Part Number	Battery	V	in	Tighten/Breakaway Nm	rpm	bpm	kg	mm	dB(A)	m/s ² /K
W5133	BL2012/2022	IQV20	3/8" □	495/745	2,100	3,300	1.68	179	82	4.5/3.0
W5153	BL2012/2022	IQV20	1/2" □	495/745	2,100	3,300	1.72	183	82	4.5/2.7
W5133P-C1D2	BL2012/2022	IQV20	3/8" □	495/745	2,100	3,300	1.72	172	90	11.3/2.6
W5153P-C1D2	BL2012/2022	IQV20	1/2" □	495/745	2,100	3,300	1.81	183	90	11.3/2.6

Cordless IQV™ Tools and Accessories | Impact Tools and Ratchets

W7152

1/2" ■ Anvil - IQV20



- 495 Nm of Forward Torque
745 Nm of Breakaway Torque
- Steel-reinforced chemical-resistant housings add strength for unmatched drop resistance
- Adjustable 360° Shadowless LED Light
- IQV Power Control System with 4 modes and Auto Shut-Off
- Powerful Brushless Motor and variable speed Trigger



Also available

W7172

3/4" Anvil Ring- IQV20

W7152P

1/2" Anvil Pin- IQV20

Protection Boot

W7150-BOOT

W7252

1/2" ■ Anvil Ring, long - IQV20



3/4" ■ Anvil - IQV20



Available in kits

Part Number

W7152-K22-AN

W7152-K22-JP

W7152-K22-KR

W7152-K22-SGHK

W7152-K22-TW

Part Number

W7152P-K22-AN

W7152P-K22-JP

W7152P-K22-KR

W7152P-K22-SGHK

Part Number

W7252-K22-AN

W7252-K22-JP

W7252-K22-KR

W7252-K22-SGHK

Part Number

W7172-K22-AN

W7172-K22-JP

W7172-K22-KR

W7172-K22-SGHK

Impact Tool, Charger 12/20 V, 2 Li-Ion Batteries & Carry Case

Part Number	Battery	V	in	Tighten/Breakaway MAX Nm	rpm	bpm	kg	mm	dB(A)	m/s ² /K
W7152	BL2022	IQV20	1/2" □	1,360/2,033	1,900	2,450	2.68	207	95.0	17.0/3.7
W7152P	BL2022	IQV20	1/2" □ Pin	1,360/2,033	1,900	2,450	2.68	207	95.0	17.0/3.7
W7252	BL2022	IQV20	1/2" □ Long	1,360/2,033	1,900	2,450	2.88	257	95.0	17.2/2.3
W7172	BL2022	IQV20	3/4" □	1,360/2,033	1,900	2,450	2.78	215	92.0	16.6/1.9

Cordless IQV™ Tools and Accessories | Impact Tools and Ratchets

W8171/8191

3/4" & 1" ■ Anvil – IQV20



- 1765 Nm of Forward Torque
2710 Nm of Breakaway Torque
- Steel-reinforced chemical-resistant housings add strength for unmatched drop resistance
- Adjustable 360° Shadowless LED Light
- IQV Power Control System with 4 modes and Auto Shut-Off
- Powerful Brushless Motor and variable speed Trigger

Available in kits

Part Number

W8171-K2-AP1

W8171-K2-JP

W8171-K2-KR

Extended Anvil

W8571-K2-AP1

W8571-K2-JP

W8571-K2-KR

3/4" or 3/4" 6" Long Anvil Impact Driver, Charger, 2 BL2022 (5.0 Ah) Li-Ion Batteries

W8571/8591

3/4" & 1" 6" Long ■ Anvil – IQV20



- 1765 Nm of Forward Torque
2710 Nm of Breakaway Torque
- Steel-reinforced chemical-resistant housings add strength for unmatched drop resistance
- Adjustable 360° Shadowless LED Light
- IQV Power Control System with 4 modes and Auto Shut-Off
- Powerful Brushless Motor and variable speed Trigger

Available in kits

Part Number

W8191-K2-AP1

W8191-K2-JP

W8191-K2-KR

Extended Anvil

W8591-K2-AP1

W8591-K2-JP

W8591-K2-KR

1" or 1" 6" Long Anvil Impact Driver, Charger, 2 BL2022 (5.0 Ah) Li-Ion Batteries

W9491/9691

1" & 6" Long ■ Anvil - IQV20



- 2980 Nm of Forward Torque
4000 Nm of Breakaway Torque
- Steel-reinforced chemical-resistant housings add strength for unmatched drop resistance
- IQV Power Control System with 3 modes
- 250 bolts per charge – tackle a full day's worth of work. Reduce set up time of jobs up to 15% compared to air tools.

Available in kits

Part Number

W9491-K4E-AN

W9491-K4E-JP

W9491-K4E-KR

W9491-K4E-SGHK

Extended Anvil

W9691-K4E-AN

W9691-K4E-JP

W9691-K4E-KR

W9691-K4E-SGHK

1" or 1" 6" Long Anvil Impact Driver, Charger, 4 BL2022 (5.0 Ah) Li-Ion Batteries

Part Number	Battery	V	in	Tighten/Breakaway Nm	rpm	bpm	kg	mm	dB(A)	m/s ² /K
W8171	BL2022	IQV20	3/4" □	1,765/2,710	1,350	1,900	3.4	223	96	14.2/2.5
W8571	BL2022	IQV20	3/4", 6" Long □	1,765/2,710	1,350	1,900	3.5	375	96	14.2/2.5
W8191	BL2022	IQV20	1" □	1,765/2,710	1,350	1,900	3.4	223	96	14.2/2.5
W8591	BL2022	IQV20	1", 6" Long □	1,765/2,710	1,350	1,900	3.5	375	96	14.2/2.5
W9491	2 x BL2022	IQV20	1" □	2,980/4,000	890	1,170	12.5	551	94	25.8/8.5
W9691	2 x BL2022	IQV20	1", 6" Long □	2,980/4,000	890	1,170	13.2	664	95.9	23.5/7.7

Cordless IQV™ Tools and Accessories | Impact Tools and Ratchets

R3130

3/8" ■ Anvil – IQV20



- 73 Nm of maximum torque
- 0-225 rpm free speed
- Variable-speed trigger allows easy starts and precise speed control



Available in kits

Part Number

R3130-K22-AUNZ

R3130-K22-JP

R3130-K22-KR

R3130-K22-SGHK

3/8" Drive Ratchet, Charger 12/20 V, 2 BL2012 (2.5 Ah) Li-Ion Battery & Case

R3150

1/2" ■ Anvil – IQV20



- 73 Nm of maximum torque
- 0-225 rpm free speed
- Variable-speed trigger allows easy starts and precise speed control



Available in kits

Part Number

R3150-K22-AUNZ

R3150-K22-JP

R3150-K22-KR

R3150-K22-SGHK

1/2" Drive Ratchet, Charger 12/20 V, 2 BL2012 (2.5 Ah) Li-Ion Battery & Case

W5350

1/2" ■ Pin Anvil - IQV20



- 245 Nm of maximum torque
- Variable speed switch with electronic brake provides maximum control of the tool
- No torque reaction
- 3,000 BPM

Also available

W5330

3/8" Tool only – IQV20

Protection Boot

W5330-BOOT



Available in kits

Part Number

W5350-K22-AUNZ

W5350-K22-JP

W5350-K22-KR

W5350-K22-SGHK

1/2" Drive Impact Angle Wrench, Charger 12/20 V, 2 BL2012 (2.5 Ah) Li-Ion Battery & Carry Case

Part Number	Battery	V	in	Nm	rpm	kg	mm	dB(A)	m/s ² /K
R3130	BL2012	IQV20	3/8"	73	225	2.00	408	86.0	2.8/0.7
R3150	BL2012	IQV20	1/2"	73	225	2.00	408	86.0	2.8/0.7
R5330	BL2012	IQV20	3/8"	245	1,850	2.06	179	85.0	10/6.3
R5350	BL2012	IQV20	1/2"	245	1,850	2.27	183	85.0	10/6.3

Cordless IQV™ Tools and Accessories | Drills & Screwdrivers

D5241

Hammer Drill - IQV20



- 125 Nm of maximum torque
- 1/2" Keyless chuck
- 24-Position Clutch to Fine Tune Fastening Depth
- Three Modes: Drill, Driver, & Hammer Drill
- Auxiliary Handle for Masonry or High Torque Applications
- LED Work Light to Illuminate workspace
- High & Low Speed Options
- Steel-reinforced housings add strength for unmatched drop resistance



Available in kits

Part Number

D5241-K22-AP1

D5241-K22-JP

D5241-K22-KR

1/2" Hammer Drill, Charger 12/20 V, 2 BL2022 (5.0 Ah) Li-Ion Batteries

D1131

Drill/Driver – IQV12



- 30 Nm of maximum torque
- 3/8" Keyless Chuck
- 21-Position Clutch to Fine Tune Fastening Depth
- Two Modes: Drill, Driver
- LED Work Light to Illuminate workspace
- High & Low Speed Options
- Steel-reinforced housings add strength for unmatched drop resistance
- Variable speed switch with electronic brake provides maximum control of the tool



Available in kits

Part Number

D1131-K22-AP

D1131-K22-JP

D1131-K22-KR

3/8" Drill/Driver, Charger 12/20 V, 2 BL1204 (2.5 Ah) Li-Ion Batteries

D3141 / 3411

Drill/Driver - IQV20



- 50 Nm of maximum torque
- 1/2" Keyless & 1/4" QC Hex
- 18-Position Clutch to Fine Tune Fastening Depth
- Two Modes: Drill, Driver
- LED Work Light to Illuminate workspace
- High & Low Speed Options
- Steel-reinforced housings add strength for unmatched drop resistance
- Variable speed switch with electronic brake provides maximum control of the tool



Available in kits

Part Number

D3141-K22-AP1

D3141-K22-JP

D3141-K22-KR

D3411-K22-AP1

D3411-K22-JP

D3411-K22-KR

1/2" Keyless & 1/4" Hex Drill/Driver, Charger 12/20V, 2 BL2012 (2.5 Ah) Li-Ion Batteries

Part Number	Battery	V	Nm	Clutch/Modes	in	bpm	rpm	kg	mm	dB(A)	m/s ² /K
D5241	BL2022	IQV20	125	24/3	1/2" Keyless	30,000	500/1,800	1.58	198	84	7.0/1.5
D1131	BL1204	IQV12	30	21/2	3/8" Keyless	N/A	100/1,700	0.72	158	64	-
D3141	BL2012	IQV20	50	18/2	1/2" Keyless	N/A	500/1,800	1.04	180	73	-
D3411	BL2012	IQV20	50	18/2	1/4" Keyless	N/A	500/1,800	0.80	127	73	-

Cordless IQV™ Tools and Accessories | Grinder & Polisher

G4621

Polisher/Sander - IQV20



- Included Side Handle Attaches Left or Right
- Threaded Chuck with Spindle Lock
- Includes 6 Attachments
- High/Low Speed Switch
- Bright LED Light Bar



- 2" & 3" Roloc
- 3" Hook & Loop Backing Pads
- 3" Wool, 3" Soft Foam
- 3" Medium Foam Pads

Available in kits

Part Number

G4621-K22-AP

G4621-K22-JP

G4621-K22-KR

Grinder/Polisher, Charger 12/20 V, 2 BL2012 (2.5 Ah) Li-Ion Batteries

G4911

Tire Buffer – IQV20



- Great tool accessibility inside small tires
- Dual Speed Selector:
 - Reaming – 1,000 RPM
 - Buffing – 3,000 RPM
- Up to 25% quieter with 50% less vibration than competitive air tools
- 7/16" Hex Quick Change Chuck for fast changes between reaming bits and buffing cones
- 40% more power than leading cordless competitor reduces buffing time up to 30%

Available in kits

Part Number

G4911-K1-AP

G4911-K1-JP

G4911-K1-KR

Tire Buffer, Charger 12/20 V, 2 BL2012 (2.5 Ah) Li-Ion Batteries

G5351M

Angle Grinder - IQV20



- Spindle-Lock (M14 Arbor) with Quick-Release Button
- Automatic E-Brake and Anti-Kick-back Protection Features
- Removable Vent Filter Protects from Dust and Metal Shavings
- Tool-Free Accessory Changes and Guard Adjustment
- Slim Handle with Comfortable Over-molded Grip



Available in kits

Part Number

G5351M-K22-AP

G5351M-K22-JP

G5351M-K22-KR

Angle Grinder, Charger 12/20 V, 2 BL2022 (5.0 Ah) Li-Ion Batteries

Part Number	Battery	V	in	Feature	rpm	kg	mm	dB(A)	m/s ² /K
G4621	BL2012	IQV20	5/16"-24UNF	Dual Speed	2,800/8,300	2.00	408	73.0	1.2/0.5
G4911	BL2012	IQV20	7/16" QC	Dual Speed	1,000/3,000	0.83	270	66.1	1.7/1.5
G5351M	BL2022	IQV20	M14	T27 (Grinding) T1 (Cutting)	8,000	2.31	337	76.3	6.6/2.1

Cordless IQV™ Tools and Accessories | Other tools

LUB5130

Grease Gun - IQV20



- Cordless Grease Gun
- Pressure 431 bar (6,250 psi)
- Flowrate 75 g/min
- Grease capacity 400 g
- 3 way loading: bulk, cartridge and manual
- Flexible hose 762 mm

Available in kits

Part Number

LUB5130-K22-AUNZ

LUB5130-K22-JP

LUB5130-K22-KR

LUB5130-K22-SGHK

20 V Grease Gun, Charger 12/20 V,
1 BL2012 (2.5 Ah) Li-Ion Battery

C5101

Recip. Saw - IQV20



- Tool-less blade clamp for quick and easy blade changes
- Adjustable shoe for operator control and blade durability
- 3,000 SPM
- 31 mm Stroke Length
- Trigger lock prevents unintended operation



Available in kits

Part Number

C5101-K22-AP

C5101-K22-JP

C5101-K22-KR

Reciprocating Saw, Charger 12/20V,
2 BL2022 (5.0 Ah) Li-Ion Batteries

H3111

Heat Gun - IQV20



- Single hand operatable two-speed switch, 7cfm and 10 cfm, with Temperature Memory Function
- Programmable display, Adjustable temperature. Each press on button adjust the temperature by 10 °C or 18 °C. Temperature range: 30-550 °C. Press (-) and (+) button at the same time to switch between Celsius and Fahrenheit
- Twist nozzle ejector to remove nozzle, avoid burnt for user
- 3 Nozzles: Flat, Round, Reflect

Available in kits

Part Number

H3111-K1-AP

H3111-K1-JP

H3111-K1-KR

Heat Gun, Charger 12/20V,
1 BL2022 (5.0 Ah) Li-Ion Battery

Part Number	Battery	V	spm	Temperature	Flow Rate	kg	mm	dB(A)	m/s ² /K
LUB5130	BL2012	IQV20	-	-	75g/min	3.70	490	66.0	<2.5
C5101	BL2022	IQV20	3,000	-	-	2.86	429	85.2	12.1/1.5
H3111	BL2022	IQV20	-	30-550°C	-	0.64	175	58.6	-

Cordless IQV™ Tools and Accessories | Batteries and Chargers

BL1204

IQV12 - 2.0 Ah Li-Ion
Compatible with all 12V cordless tools



- Performance - Each battery provides
- 2.5 Ah of 12 V power, intelligently managed by the IQV12 Series system for maximum tool runtime
- Durability - Positive-lock system emits highly audible click when properly secured in tool, helping to eliminate drops and damage
- Ergonomics - Fuel gauge and patent-pending dual side button design for easier battery installation

BL2012

IQV20 - 2.5 Ah, Li-Ion
Compatible with all 20V cordless tools



- Performance: The BL2012 x2.5 delivers 100% longer run time than its predecessor at the same size and weight.
- Ergonomic: patent-pending dual side button designed for easier battery installation.
- Durability: The intelligent Battery Management System (BMS) allows the battery to communicate with the tool and charger to offer triple battery protection, prevent over loading, over charging and over discharging for longer tool and battery life.

Also available
BL2012-AP5

Protection Boot
BL2005-BOOT

BL2022



20 V - 5.0 Ah, Li-Ion
Compatible with all 20V cordless tools



- Performance: The BL2022 x5.0 delivers 68% longer run time than its predecessor at the same size and weight.
- Ergonomic: patent-pending dual side button designed for easier battery installation.
- Durability: The intelligent Battery Management System (BMS) allows the battery to communicate with the tool and charger to offer triple battery protection, prevent over loading, over charging and over discharging for longer tool and battery life.

Also available
BL2022-AP5

Protection Boot
BL2010-BOOT

Part Number	 V	 kg
BL1204	12V Max	0.21
BL2012	20V Max	0.41
BL2022	20V Max	0.72

Cordless IQV™ Tools and Accessories | Batteries and Chargers

BL1121

Charger IQV12/IQV20 batteries



- Versatility: One charger for all your Ingersoll Rand batteries, fully compatible with all existing 20 V and 12 V batteries and that can charge USB mobile devices
- Durability: Engineered composite housing withstands wear, abrasions, drops, and can be securely screw mounted to a wall or toolbox
- An LED Fuel Gauge and audible alarm will let you know when your batteries are fully charged

Also available

BC1121-AP3
BC1121-AP4
BC1121-AP5
BC1121-AP6

BC1124

Charger IQV12/IQV20 batteries



- Versatility: One charger for all your Ingersoll Rand batteries, fully compatible with all existing 20 V and 12 V batteries.
- Smaller & lighter comparing to BC1121, saving room for work-space
- Durability: Engineered composite housing withstands wear, abrasions, drops, and can be securely screw mounted to a wall or toolbox
- An LED Fuel Gauge and audible alarm will let you know when your batteries are fully charged

Also available

BC1124-ANZ
BC1124-JP
BC1124-KR
BC1124-SHK



BC1221



Dual-Bay charger
 IQV12/IQV20 batteries



- Versatility: One charger for all your Ingersoll Rand batteries, fully compatible with all existing 20 V and 12 V batteries and that can charge USB mobile devices
- Capable of charging 2 battery packs simultaneously
- Durability: Engineered composite housing withstands wear, abrasions, drops, and can be securely screw mounted to a wall or toolbox
- An LED Fuel Gauge and audible alarm will let you know when your batteries are fully charged

Included in W9000 series Kit

Part Number	 V	 kg
BL1124	IQV12/IQV20	0.58
BC1221	IQV12/IQV20	0.91
BC1121	IQV12/IQV20	0.77

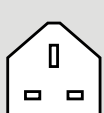
Type of Power Plug			
			
AP3	AP4	AP5	AP6
Japan	Australia/ New Zealand	Korea	Singapore/ Hongkong



Even though you never know what challenge the day will bring, one thing is certain – the Impactool™ range has the power to answer it.



Air Impactools™

- 20 | 1/4" and 3/8"
- 24 | 1/2"
- 30 | 3/4"
- 34 | 1" (pistol and rear handle)
- 40 | Accessories

Torque is key to Jose dos Santos. With Ingersoll Rands industry-leading range of Air Impactools™ he has all the power he needs at his fingertips. After having tested them, the tools have proven to deliver more performance than he was expecting. And the wide range of sizes offers him the perfect match for his workplace.

Jose dos Santos, Bilbao

Air Impacttools™



2101XPA 1/4" ■ Ring type



- Powerful impact mechanism delivers 75 Nm of max torque
- Hard-hitting five-vane motor for smooth and robust performance
- Easily accessible forward/reverse switch for one-handed operation
- Ideal for those hard-to-reach places where conventional tools can't go

Also available
2102XPA
 3/8" Ring type
2101XPA-QC
 1/4" Hex Quick change

Available in kits
2101KA
 CCN: 47520766001



Includes 1/4" impact and 10 sockets set

Part Number	CCN	in	Nm	Nm	rpm	bpm	kg	mm	NPT	mm	l/s	l/s	dB(A)	m/s ² /K ⁽¹⁾
2101XPA	47520745001	1/4" □	75	34 - 68	14,500	3,650	0.70	175	1/4"	10	4.7	6.4	84.8	3.0/1.0
2102XPA	47520747001	3/8" □	75	34 - 68	14,500	3,650	0.70	175	1/4"	10	4.7	6.4	84.8	3.0/1.0
2101XPA-QC	47520746001	1/4" ○	75	34 - 68	14,500	3,650	0.70	183	1/4"	10	4.7	6.4	84.8	3.0/1.0

⁽¹⁾ ISO28927 – 3-axis measurement: vibration level/measurement uncertainty.

Performance at 6.2 bar (90 psi)

Air Impacttools™ | 1/4" and 3/8"

15QMAX

3/8" ■ Ring type



- Delivering 520 Nm of maximum reverse torque at only 1.09 kg
- Push buttons for one-hand forward/reverse
- 3-mode selection power regulator
- 117 mm length
- Quiet Tool

also available:

35MAX

1/2" Ring type

Protection Boot

35-BOOT

CCN: 47544405001

2115TiMAX-AP

3/8" ■ Ring type



- 407 Nm of maximum torque in reverse
- Only 1.13 kg and 151 mm
- Twin-hammer impact mechanism
- Titanium hammer case and composite housing
- 4-position power regulator
- 1-hand forward and reverse switch

also available:

2115QTiMAX Quiet

2115PTiMAX-AP

Pin type

2125QTiMAX-AP Quiet

1/2" Ring type

2125PTiMAX

1/2" Pin type

Protection Boot

2115M-BOOT

CCN: 45587326

2015MAX

3/8" ■ Ring type



- 244 Nm of maximum torque in reverse
- Only 1.54 kg
- Jumbo-hammer impact mechanism
- Composite housing
- 2-position power regulator
- no counter force

also available:

2025MAX

1/2" Ring type

Protection Boot

2015-BOOT

CCN: 45533775

Part Number	CCN	in	Nm	Nm	rpm	bpm	kg	mm	NPT	mm	l/s	l/s	dB(A)	m/s ² /K ⁽¹⁾
15QMAX	47544405001	3/8" □	520	420	6,000	1,350	1.09	117	1/4"	10	1.9	8.02	89.7	5.5/0.9
35MAX	47544404001	1/2" □	610	490	8,000	1,250	1.09	117	1/4"	10	1.9	8.02	95.9	6.4/1.0
2115TiMAX-AP	48387864	3/8" □	407	34 - 312	15,000	1,500	1.13	151	1/4"	10	1.9	8.00	93.2	7.5/1.8
2115QTiMAX	45587326	3/8" □	407	34 - 312	15,000	1,500	1.13	151	1/4"	10	1.9	8.00	93.2	7.5/1.8
2115PTiMAX-AP	48387872	3/8" □	407	34 - 312	15,000	1,500	1.13	151	1/4"	10	1.9	8.00	93.2	7.5/1.8
2125QTiMAX-AP	48387880	1/2" □	450	34 - 340	15,000	1,500	1.14	155	1/4"	10	1.9	8.00	93.2	7.5/1.8
2125PTiMAX	45587565	1/2" □	450	34 - 340	15,000	1,500	1.13	151	1/4"	10	1.9	8.00	93.2	7.5/1.8
2015MAX	45533775	3/8" □	244	61 - 217	9,000	2,100	1.54	332	1/4"	10	1.6	9.00	96.6	17.4/3.0
2025MAX	47099247	1/2" □	244	61 - 217	9,000	2,100	1.54	332	1/4"	10	1.7	9.00	96.6	17.4/3.0

⁽¹⁾ ISO28927 – 3-axis measurement: vibration level/measurement uncertainty.

Performance at 6.2 bar (90 psi)

Air Impacttools™ | 1/4" and 3/8"

2115Qi

3/8" ■ Ring type



- 407 Nm of maximum torque in reverse
- Only 1.13 kg and 151 mm
- Twin-hammer impact mechanism
- Aluminum hammer case and composite housing
- 4-position power regulator
- 1-hand forward and reverse switch

Also available

2125Qi

1/2" Ring type

Protection Boot

2115-BOOT

CCN: 45505351

211

3/8" ■ Ring type



- 204 Nm of maximum torque in reverse
- Only 1.09 kg
- Jumbo-hammer impact mechanism
- 5-position power regulator

212A

3/8" ■ Ring type



- 244 Nm of maximum torque in reverse
- Pressure-feed lubrication system automatically greases the impact mechanism for increased durability and reliability
- Wide range of power regulator settings helps adjusting the power to the application
- Only 1.31 kg

Also available

222A

1/2" Ring type

Protection Boot

212-BOOT

CCN: 45505344



Part Number	CCN	in	Nm	Nm	rpm	bpm	kg	mm	NPT	mm	l/s	l/s	dB(A)	m/s ² /K ⁽¹⁾
2115Qi	45588076	3/8" □	407	34 - 312	15,000	1,500	1.13	151	1/4"	10	1.9	8.00	94.0	7.5/1.8
2125Qi	45604287	1/2" □	450	34 - 340	15,000	1,500	1.14	155.0	1/4"	10	1.9	8.00	94.00	7.5/1.8
211	1197060	3/8" □	204	27 - 170	10,000	1,500	1.09	168	1/4"	10	1.2	5.20	104.0	5.9/1.6
212A (222A-1/2" □)	45765294	3/8" □	244	27 - 170	10,000	1,500	1.31	152	1/4"	10	1.2	5.20	97.5	6.5/1.0

⁽¹⁾ ISO28927 – 3-axis measurement: vibration level/measurement uncertainty.

Performance at 6.2 bar (90 psi)

Air Impacttools™ | 1/4" and 3/8"

216B

3/8" ■ Ring type



- 271 Nm of maximum torque in reverse
- Only 1.27 kg
- Ball & cam impact mechanism
- Power regulator

LA158

3/8" ■ Ring type



- 136 Nm of maximum torque in reverse
- Small size to allow greater access to tight spaces
- Easy glide forward/reverse switch
- Wide range of power regulator settings helps adjusting the power to the application

Part Number	CCN	in	Nm	Nm	rpm	bpm	kg	mm	NPT	mm	l/s	l/s	dB(A)	m/s ² /K ⁽¹⁾
216B	46806600	3/8"	271	20 - 217	8,500	1,600	1.27	196	1/4"	10	1.4	9.00	90.0	5.2/1.0
LA158	49825870	3/8"	136	7 - 100	1,000	1,400	1.25	137	1/4"	10	1.9	7.50	88.4	3.3/1.1

⁽¹⁾ ISO28927 – 3-axis measurement: vibration level/measurement uncertainty.

Performance at 6.2 bar (90 psi)

Air Impacttools™



2236QTIMAX 1/2" ■ Ring type



- 1,356 Nm of maximum reverse torque and 2,034 Nm of Nut busting Torque
- Patented DXS Drive Xchange System™
- 10 different available drive options
- Titanium hammer case and composite housing
- Patented Direct Hammer Greasing System

Also available

- **2236QTIMAX-2** Quiet
1/2 x 2" Ring type
- **2236QPTIMAX** Quiet
1/2" Pin type

Drive Kits

- **AK32H** 2-pc Kit includes: 3/8", 1/2" Std
- **AK33H** 3-pc Kit includes: 3/8", 1/2" Std, 3/4" Std
- **AK42H** 2-pc Kit includes: 1/2 x 2" Ext, 3/4" Std
- **AK43H** 3-pc Kit includes: 1/2 x 2" Ext, 1/2 x 4" Ext, 3/4" Std
- **AK62H** 2-pc Kit includes: 1/2" Std, 3/4" Std
- **EAK62H** 2-pc Kit includes: 3/4" Std, 3/4 x 6" Ext
- **EAK44H** 4-pc Kit includes: 1/2 x 4" Ext, 6" Ext, 8" Ext, 10" Ext

Part Number	CCN	in	Nm	Nm	rpm	bpm	kg	mm	NPT	mm	l/s	l/s	dB(A)	m/s ² /K ⁽¹⁾
2236QTIMAX	2236QTIMAX	1/2" □	1,356	1,220	7,500	1,350	1.99	187.0	3/8"	13	4.3	18.2	94.2	11.4/4.3
2236QTIMAX-2	2236QTIMAX-2	1/2"x2" □	1,356	1,220	7,500	1,350	2.10	238.0	3/8"	13	4.3	18.2	94.2	11.4/4.3
2236QPTIMAX	2236QPTIMAX	1" □	1,356	1,220	7,500	1,350	1.99	187.0	3/8"	13	4.3	18.2	94.2	11.4/4.3

⁽¹⁾ ISO28927 – 3-axis measurement: vibration level/measurement uncertainty.

Performance at 6.2 bar (90 psi)

Air Impacttools™ | 1/2"

35MAX

1/2" ■ Ring type



- Delivering 610 Nm of maximum reverse torque and 750 Nm of nut busting torque at only 1.09 kg
- Push buttons for one-hand forward/reverse
- 3-mode selection power regulator
- 117 mm length
- Twin Hammer mechanism for low vibrations

Also available

36MAX

1/2" Ring type

36QMAX Quiet

1/2" Ring type

Protection Boot

35-BOOT

CCN: 47544404001

2135TiMAX-AP

1/2" ■ Ring type



- 1057 Nm
- Only 1.84 kg
- Twin-hammer impact mechanism
- Titanium hammer case and composite housing
- 1-hand forward and reverse switch

Also available

2135QTiMAX-AP Quiet

2135PTiMAX-AP

Pin-type

2135QPTiMAX-AP Quiet

Pin-type

Protection Boot

2135M-BOOT

CCN: 47517913001

2235TiMAX

1/2" ■ Ring type



- MAX Power with 1,220 Nm of maximum torque in reverse and 1,760 Nm of nut busting torque
- MAX DURABILITY with the titanium hammercase, the steel-wear plate and composite housing

Also available

2235TiMAX-2

Ring type (50 mm anvil)

2235QTiMAX Quiet

2235QTiMAX-2 Quiet

Ring type (50 mm anvil)

2235PTiMAX

Pin type

2235QPTiMAX Quiet

Pin type

Protection Boot

2235M-BOOT

CCN: 47517574001

Part Number	CCN	in	Nm	Nm	rpm	bpm	kg	mm	NPT	mm	l/s	l/s	dB(A)	m/s ² /K ⁽¹⁾
35MAX	47544404001	1/2" □	610	490	8,000	1,250	1.09	117	1/4"	10	1.90	8.02	95.9	6.4/1.0
36MAX	47608979001	1/2" □	700	600	11,000	1,300	1.09	113	1/4"	10	2.35	8.40	97.1	6.8/1.3
36QMAX	36QMAX	1/2" □	640	520	8,000	1,300	1.18	117.0	1/2"	10	11.3	8.97	91.3	8.1/1.2
2135TiMAX-AP	48387831	1/2" □	1,057	68 - 746	9,800	1,250	1.79	186.7	1/4"	10	2.4	9.40	109.00	13.3/4.6
2135QTiMAX-AP	48387856	1/2" □	1,057	68 - 746	9,800	1,250	1.84	187.0	1/4"	10	2.4	11.30	94.20	13.3/4.6
2135PTiMAX-AP	48387849	1/2" □	1,054	68 - 746	9,800	1,250	1.79	187.0	1/4"	10	2.4	9.40	99.80	13.3/4.6
2135QPTiMAX-AP	45535572CGZ	1/2" □	1,057	68 - 746	9,800	1,250	1.84	187.0	1/4"	10	2.4	9.40	94.20	13.3/4.6
2235TiMAX	2235TiMAX	1/2" □	1,260	1,220	8,500	1,200	2.1	193.0	1/4"	10	2.83	11.00	98.0	9.0/2.8
2235TiMAX-2	2235TiMAX-2	1/2" □	1,260	1,220	8,500	1,200	2.2	244.0	1/4"	10	2.83	11.00	98.0	2.7/2.7
2235QTiMAX	2235QTiMAX	1/2" □	1,220	1,180	8,500	1,200	2.1	193.0	1/4"	10	2.83	11.00	88.7	9.0/2.8
2235QTiMAX-2	2235QTiMAX-2	1/2" □	1,220	1,180	8,500	1,200	2.3	244.0	1/4"	10	2.83	11.00	88.7	2.7/2.7
2235PTiMAX	2235PTiMAX	1/2" □	1,260	1,220	8,500	1,200	2.1	193.0	1/4"	10	2.83	11.00	98.0	9.0/2.8
2235QPTiMAX	2235QPTiMAX	1/2" □	1,220	1,180	8,500	1,200	2.1	193.0	1/4"	10	2.8	11.00	88.7	9.0/2.8

⁽¹⁾ ISO28927 – 3-axis measurement: vibration level/measurement uncertainty.

Performance at 6.2 bar (90 psi)

Air Impacttools™ | 1/2"

2025MAX

1/2" ■ Ring type



- 244 Nm of maximum torque in reverse
- Only 1.54 kg
- Jumbo-hammer impact mechanism
- Composite housing
- 2-position power regulator

Also available

2015MAX

3/8" Ring type

Protection Boot

2015-BOOT

CCN: 45533775

2125Qi Quiet

1/2" ■ Ring type



- 450 Nm
- only 1.14 kg and 155 mm
- Twin-hammer impact mechanism
- Aluminum hammer case and composite housing
- 1-hand forward and reverse switch
- 4-position power regulator

Protection Boot

2115M-BOOT

CCN: 45587326

2135Qi Quiet

1/2" ■ Ring type



- 949 Nm
- Only 1.9 kg
- Twin-hammer impact mechanism
- Aluminum hammer case and composite housing
- 1-hand forward and reverse switch

Protection Boot

2135-BOOT

CCN:45505377

Part Number	CCN	in	Nm	Nm	rpm	bpm	kg	mm	NPT	mm	l/s	l/s	dB(A)	m/s ² /K ⁽¹⁾
2025MAX	47099247	1/2" □	244	61 - 217	9,000	2,100	1.54	332.0	1/4"	10	1.7	9.00	96.60	17.4/3.0
2015MAX	45533775	3/8" □	244	61 - 217	9,000	2,100	1.54	332	1/4"	10	1.6	9.00	96.6	17.4/3.0
2125Qi	45604287	1/2" □	450	34 - 340	15,000	1,500	1.14	155	1/4"	10	1.9	8.00	94.0	7.5/1.8
2135Qi	45552213	1/2" □	949	68 - 746	8,900	1,250	1.90	187	1/4"	10	2.4	11.30	95.5	13.3/4.6

⁽¹⁾ ISO28927 – 3-axis measurement: vibration level/measurement uncertainty.

Performance at 6.2 bar (90 psi)

Air Impacttools™ | 1/2"

2130AP

1/2" ■ Ring type



- 816 Nm maximum torque in reverse
- Ergonomic composite housing is lightweight, protects from cold air, and offers great operator comfort
- Full-stroke tease throttle
- Multi-position power management and easy glide forward/reverse switch

Also available

2130AP-2

Ring type (50 mm anvil)

2130XP-TL

Ring type (Torque Limited at 75 Nm)

Protection Boot

2130-BOOT

CCN: 80136112

132U-R

1/2" ■ Ring type



- 1,026 Nm of maximum torque
- Twin-hammer mechanism
- Only 1.9 kg, ergonomic composite housing offers great operator comfort

Also available

132U-G

Ring type



231C-AP

1/2" ■ Ring type



- 610 Nm
- Twin-hammer impact mechanism
- Steel hammer case
- 5-position power regulator

Also available

231HA

Ring type

231HA-2

Ring type (50 mm anvil)

Protection Boot

231-BOOT

CCN: 10566255

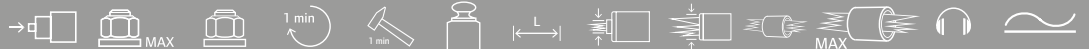

Part Number	CCN	in	Nm	Nm	rpm	bpm	kg	mm	NPT	mm	l/s	l/s	dB(A)	m/s ² /K ⁽¹⁾
2130AP	80093727	1/2" □	745	68 - 680	9,500	1,200	1.90	187	1/4"	10	2.1	10.40	94.3	8.9/2.0
2130AP-2	80093735	1/2" □	745	68 - 680	9,500	1,200	1.90	235	1/4"	10	2.1	10.40	94.3	8.9/2.0
2130XP-TL	46812251	1/2" □	816	47 - 75	7,800	1,150	1.90	187	1/4"	10	2.1	14.20	94.4	10.0/1.5
132U-R	47609122001	1/2" □	1,026	875	9,500	1,150	1.94	184	1/4"	10	2.1	10.40	94.0	-
132U-G	47609121001	1/2" □	1,026	875	9,500	1,150	1.94	184	1/4"	10	2.1	10.40	94.0	-
231C-AP	01388461	1/2" □	813	34 - 407	8,000	1,200	2.63	185	1/4"	10	2.0	10.40	99.0	-
231HA	80100514	1/2" □	800	34 - 407	8,000	1,150	2.63	185	1/4"	10	2.0	10.40	94.0	-
231HA-2	80100506	1/2" □	800	34 - 407	8,000	1,150	2.76	236	1/4"	10	2.0	10.40	94.0	-

⁽¹⁾ ISO28927 – 3-axis measurement: vibration level/measurement uncertainty.

Performance at 6.2 bar (90 psi)

Air Impacttools™ | 1/2"

131S-EA

1/2" ■ Ring type



- 610 Nm, reverse bias
- Handle exhaust
- Twin-hammer impact mechanism
- 5-position power regulator

E131

1/2" ■ Ring type



- 678 Nm, reverse bias
- Front exhaust
- Twin-hammer impact mechanism
- Efficient performance at economical price

E132

1/2" ■ Ring type



- 750 Nm of maximum reverse torque
- Handle exhaust
- Twin-hammer impact mechanism
- 3-position Forward power regulator
- Efficient performance at economical price

Part Number	CCN	in	Nm	Nm	rpm	bpm	kg	mm	NPT	mm	l/s	l/s	dB(A)	m/s ² /K ⁽¹⁾
131S-EA	01372416	1/2" □	610	34 - 475	8,000	1,225	2.63	185	1/4"	10	2.0	-	90.7	5.2
E131	46811063	1/2" □	678	34 - 475	8,750	1,175	2.60	192	1/4"	10	2.0	13.60	98.0	7.8/2.4
E132	E132	1/2" □	750	40 - 600	10,000	1,250	2.40	187.3	1/4"	10	19.8	11.30	90.2	8.2/1.5

⁽¹⁾ ISO28927 – 3-axis measurement: vibration level/measurement uncertainty.

Performance at 6.2 bar (90 psi)

Air Impacttools™ | 1/2"

232TGSL

1/2" ■ Ring type



- 10,000 rpm, fastest 1/2" impact tool
- 847 Nm, reverse bias
- Twin-hammer impact mechanism

236

1/2" ■ Ring type



- 610 Nm of maximum torque in reverse
- Pressure-fed lubrication
- Feather-touch trigger allows precise delivery of power and speed

Protection Boot

236-BOOT

CCN: 80171879

244A

1/2" ■ Ring type



- 678 Nm, non-biased
- Front exhaust
- Twin-hammer impact mechanism

Also available

244A-2

Ring type (50 mm anvil)

Part Number	CCN	in	Nm	Nm	rpm	bpm	kg	mm	NPT	mm	l/s	l/s	dB(A)	m/s ² /K ⁽¹⁾
232TGSL	89942403	1/2" □	847	54 - 544	10,000	1,200	2.72	185	1/4"	10	2.6	10.90	105.0	-
236	80171879	1/2" □	610	34 - 306	7,400	1,200	2.40	180	1/4"	10	2.0	11.30	90.3	12.0/1.0
244A	01388412	1/2" □	678	54 - 470	7,000	1,300	2.72	185	1/4"	10	2.6	10.00	93.0	8.7/0.8
244A-2	01388420	1/2" □	678	54 - 470	7,000	1,300	2.85	241	1/4"	10	2.6	10.00	93.0	-

⁽¹⁾ ISO28927 – 3-axis measurement: vibration level/measurement uncertainty.

Performance at 6.2 bar (90 psi)

Air Impacttools™



2146Q1MAX

3/4" ■ Ring & Thru-hole type



- 1,970 Nm of maximum reverse torque
- Cold-forged twin hammer impact mechanism
- Steel hammer case and composite housing
- Innovative built-in pressure gauge
- Push button for one-hand forward/reverse

Also available

2146Q1MAX-3 Quiet

3/4" x 3" Ring & Thru-hole type

2146Q1MAX-6 Quiet

3/4" x 6" Ring & Thru-hole type

2146Q2MAX Quiet

1" Ring & Thru-hole type

Protection Boot

2146-BOOT

CCN: 2146-Boot



Part Number	CCN	in	Nm	Nm	rpm	bpm	kg	mm	NPT	mm	l/s	l/s	dB(A)	m/s ² /K ⁽¹⁾
2146Q1MAX	2146Q1MAX	3/4" □	1,970	270 - 1,360	5,500	1,075	3.50	215.0	3/8"	13	6.6	18.2	94.3	8.4/3
2146Q1MAX-3	2146Q1MAX-3	3/4" x 3" □	1,970	270 - 1,360	5,500	1,075	4.00	291.0	3/8"	13	6.6	18.2	94.3	8.4/3
2146Q1MAX-6	2146Q1MAX-6	3/4" x 6" □	1,970	270 - 1,360	5,500	1,075	4.60	368.0	3/8"	13	6.6	18.2	94.3	8.4/3
2146Q2MAX	2146Q2MAX	1" □	1,970	270 - 1,360	5,500	1,075	3.60	215.0	3/8"	13	6.6	18.2	94.3	8.4/3

⁽¹⁾ ISO28927 – 3-axis measurement: vibration level/measurement uncertainty.

Performance at 6.2 bar (90 psi)

Air Impacttools™ | 3/4"

2141

3/4" ■ Ring type



- Built-in power regulator
- In-handle exhaust (pistol models)
- Twin Hammer mechanism
- Composite housing
- Steel hammer case

2145QiMAX-AP

3/4" ■ Ring & Thru-hole type



- 1,830 Nm of maximum torque in reverse
- Ergonomic composite housing is lightweight, protects from cold air and offers great operator comfort
- The low weight of this tool will reduce operator fatigue
- 360° swivel inlet helps eliminate twisted hoses
- Ring & hole-through anvil

Also available

2145QiMAX-3 Quiet

Ring&Thru-hole type (Long anvil 75 mm)

2145QiMAX-6 Quiet

Ring&Thru-hole type (Long anvil 150 mm)

2155QiMAX Quiet

1" Ring&Thru-hole type (Ring type anvil)

Protection Boot

2145M-BOOT

CCN: 45624327

2161XP

3/4" ■ Ring type



- 1,695 Nm
- Only 5.4 kg (2161XP)
- Twin-hammer impact mechanism
- Steel hammer case
- 3-position power regulator

Also available

2161XP-6

Ring type (Long anvil 150 mm)

2171XP

1" Ring type

2171XP-6

1" Ring&Thru-hole type

(Long anvil 150 mm)

Protection Boot

2161-BOOT

CCN: 01372085



Part Number	CCN	in	Nm	Nm	rpm	bpm	kg	mm	NPT	mm	l/s	l/s	dB(A)	m/s ² /K ⁽¹⁾
2141	89935597	3/4" □	1,627	271 - 1,220	7,250	1,175	3.20	208	3/8"	13	-	-	-	-
2145QiMAX-AP	48387898	3/4" □	1,830	271 - 1,220	6,300	1,150	3.35	217	3/8"	13	4	15.10	91.1	8.7/2.7
2145QiMAX-3	47119524	3/4" □	1,830	271 - 1,220	6,300	1,150	3.79	293	3/8"	13	4	15.10	96.3	8.1/1.2
2145QiMAX-6	47121454	3/4" □	1,830	271 - 1,220	6,300	1,150	4.23	369	3/8"	13	4	15.10	96.3	8.1/1.2
2155QiMAX	47123450	1" □	1,830	271 - 1,220	7,000	1,150	3.36	225	3/8"	13	4	15.10	96.3	8.7/2.7
2161XP	01372085	3/4" □	1,695	407 - 1,360	6,000	1,025	5.35	216	3/8"	13	4.7	21.50	98.0	9.8/1.8
2161XP-6	01372093	3/4" □	1,695	407 - 1,360	6,000	1,025	5.94	370	3/8"	13	4.7	21.50	98.0	9.8/1.8
2171XP	01378165	1" □	1,695	408 - 1,360	6,000	1,025	5.47	226	3/8"	13	4.7	21.50	94.7	10.3/1.3
2171XP-6	16619801	1" □	1,695	408 - 1,360	6,000	1,025	5.95	318	1/2"	13	4.7	21.50	94.7	9.9/3.0

⁽¹⁾ ISO28927 – 3-axis measurement: vibration level/measurement uncertainty.

Performance at 6.2 bar (90 psi)

Air Impacttools™ | 3/4"

259

3/4" ■ Ring type



- 1,424 Nm
- Only 4.0 kg and 218 mm
- Swinging-hammer impact mechanism
- 2-position power regulator

Protection Boot

259-BOOT

CCN: 45631918

261

3/4" ■ Ring type



- 1,627 Nm
- Jumbo-hammer impact mechanism
- Steel hammer case
- Continuous power regulator

Also available

261-3

Ring type (Long anvil 75 mm)

261-6

Ring type (Long anvil 150 mm)

271

1" Ring type

Protection Boot

261-BOOT

CCN: 01209758

Part Number	CCN	in	Nm	Nm	rpm	bpm	kg	mm	NPT	mm	l/s	l/s	dB(A)	m/s ² /K ⁽¹⁾
259	45631918	3/4" □	1,424	271 - 1,085	6,000	1,000	4.00	218	3/8"	10	3.8	14.20	91.6	6.4/0.8
261	01209758	3/4" □	1,627	272 - 1,224	5,500	1,000	5.62	224	3/8"	13	4.5	17.90	98.1	10.4/1.3
261-3	01211101	3/4" □	1,627	272 - 1,224	5,500	1,000	5.90	300	3/8"	13	4.5	17.90	98.1	10.4/1.3
261-6	01217199	3/4" □	1,627	272 - 1,224	5,500	1,000	6.21	376	3/8"	13	4.5	17.90	98.1	10.4/1.3
271	01209766	1" □	1,627	136 - 1,017	5,500	1,000	5.67	226	3/8"	13	4.5	17.90	98.1	13.2/1.1

⁽¹⁾ ISO28927 – 3-axis measurement: vibration level/measurement uncertainty.

Performance at 6.2 bar (90 psi)

Air Impacttools™



2850MAX-6

1" ■ Long anvil 150 mm
(Ring&Thru-hole type)



- Provides maximum torque of 2,850 Nm with a light weight design of only 9.8 kg
- Highly engineered robust motor design maintains power in extreme working conditions
- Chemical resistant housing and solid steel impact mechanism provides reliability and durability

Also available

2850MAX

Ring&Thru-hole type (Short anvil)

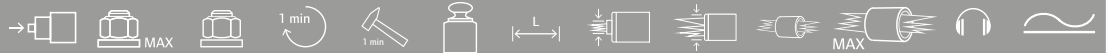

Part Number	CCN	in	Nm	Nm	rpm	bpm	kg	mm	NPT	mm	l/s	l/s	dB(A)	m/s ² /K ⁽¹⁾
2850MAX-6	2850MAX-6	1" □	2,850	2,715	5,500	770	9.80	486	1/2"	19	6.61	26.45	96.7	10.3/1.9
2850MAX	2850MAX	1" □	2,850	2,715	5,500	770	8.80	334	1/2"	19	6.61	26.45	96.7	12.6/3.6

⁽¹⁾ ISO28927 – 3-axis measurement: vibration level/measurement uncertainty.

Performance at 6.2 bar (90 psi)

Air Impacttools™ | 1" (pistol and rear angle)

285B-6

1" ■ Long anvil 150 mm
(Ring&Thru-hole type)



- Designed for operation at 8.3 bar dynamic (120 psi)
- 2,400 Nm
- Swinging-hammer impact mechanism
- 3-position power regulator

Also available

285B

Short anvil (Ring&Thru-hole type)

285B-6-AP

Outside trigger, 45 degree air inlet bushing

285B-S6

#5 Spline Drive, long 150 mm anvil

280-6

1" ■ Long anvil 150 mm
(Thru-hole type)



- 2,169 Nm
- Jumbo-hammer impact mechanism

Also available

280

Short anvil (Thru-hole type)

280-S-6

#5 Spline Drive, long anvil 150 mm

631L

1" ■ Long anvil 200 mm
(Ring&Thru-hole type)



- 4,300 Nm of maximum torque
- Ergonomic auxiliary handle provides excellent manoeuvrability
- 4-position power regulator and forward/reverse control

Also available

631S

Short anvil (Ring&Thru-hole type)

Available in kits

631LSK

CCN: 45514684

2 pcs 41 mm hex socket (90 mm long)
& 2 pcs 21 mm female square budd wheel socket (60 mm long)

Part Number	CCN	in	Nm	Nm	rpm	bpm	kg	mm	NPT	mm	l/s	l/s	dB(A)	m/s ² /K ⁽¹⁾
285B-6	80157233	1" □	2,000(2)	136 - 1,220	5,000	700	12.60	511	1/2"	19	5.2	21.70	99.8	9.0/2.7
285B	80157209	1" □	2,000(2)	136 - 1,220	5,000	700	11.20	335	1/2"	19	5.2	21.70	99.8	8.0/1.2
285B-6-AP	80159191	1" □	2,000(2)	136 - 1,220	5,000	700	12.60	519	1/2"	13	4.7	17.50	99.8	9.0/2.7
285B-S6	80157308	1" □	2,000(2)	136 - 1,220	5,000	700	12.60	519	1/2"	19	5.2	21.70	99.8	9.0/2.7
280-6	01173046VIM	1" □	2,169	204 - 1,360	6,000	750	10.80	470	1/2"	13	4.7	26.00	109.1	21.8/3.8
280	01231265	1" □	2,169	204 - 1,360	6,000	750	9.98	330	1/2"	13	4.7	26.00	109.1	24.1/3.4
280-S-6	01173095	1" □	2,169	204 - 1,360	6,000	750	10.80	470	1/2"	13	4.7	26.00	109.1	21.8/3.8
631L	80183171	1" □	4,300	271 - 3,390	3,500	700	16.60	624	1/2"	13	7.1	26.40	108.4	12.7/2.5
631S	45504701	1" □	4,300	271 - 3,390	3,500	700	-	-	1/2"	13	7.1	26.40	108.4	12.7/2.5

⁽¹⁾ ISO28927 – 3-axis measurement: vibration level/measurement uncertainty.

Performance at 6.2 bar (90 psi)

Air Impacttools™ | 1" (pistol and rear angle)

E688-8

1" ■ Long anvil 200 mm
(Ring&Thru-hole type)



- 3800Nm Nm of maximum reverse torque at 120 PSI
- Heat-treated, precision-machined hammer mechanism
- Pinless single swinging-hammer impact mechanism
- 3-position forward/Reverse power regulator
- Designed for heavy truck maintenance

E699-8

1" ■ Long anvil 200 mm
(Ring&Thru-hole type)

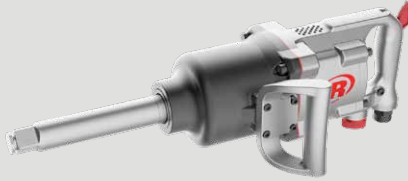

- 4,900 Nm of maximum reverse torque at 120 PSI
- High strength steel impact mechanism and rotor
- Pinless single swinging-hammer impact mechanism
- 3-position forward/Reverse power regulator
- Designed for heavy truck maintenance

2155QiMAX

1" ■ Short anvil (Ring type)



- 1,830 Nm of maximum torque in reverse
- Ergonomic composite housing is lightweight, protects from cold air and offers great operator comfort
- The low weight of this tool will reduce operator fatigue
- 360° swivel inlet helps eliminating twisted hoses
- Ring&hole- through

Protection Boot

2145M-BOOT

CCN: 47123450

Part Number	CCN	in	Nm	Nm	rpm	bpm	kg	mm	NPT	mm	l/s	l/s	dB(A)	m/s ² /K ⁽¹⁾
E688-8	48483747	1" □	3,180	271 - 3,100	4,100	625	16.5	630	1/2"	13	51	34.00	100.5	-
E699-8	E699-8	1" □	4,300	360 - 3,400	4,550	750	16.90	578.2	1/2"	13	48.6	31.8	97.7	10.5/1.5
2155QiMAX	47123450	1" □	1,830	271 - 1,220	6,300	1,150	3.36	225	3/8"	13	4.0	15.10	96.3	8.7/2.7

⁽¹⁾ ISO28927 – 3-axis measurement: vibration level/measurement uncertainty.

Performance at 6.2 bar (90 psi)

Air Impacttools™ | 1" (pistol and rear angle)

2146Q2MAX

1" ■ Short anvil (Ring&Thru-hole type)



- 1,970 Nm of maximum reverse torque
- Cold-forged twin hammer impact mechanism
- Steel hammer case and composite housing
- Innovative built-in pressure gauge
- Push button for one-hand forward/reverse

Protection Boot

2146-BOOT

CCN: 2146-Boot

2171XP

1" ■ Short anvil (Ring type)



- 1,695 Nm
- Only 5.47 kg (2171XP)
- Twin-hammer impact mechanism
- Steel hammer case
- 3-position power regulator

Also available

2171XP-6

Ring&Thru-hole type (Long anvil 150 mm)

Protection Boot

2161-BOOT

CCN: 01372085

271

1" ■ Short anvil (Hole-through)



- 1,491 Nm
- Jumbo-hammer impact mechanism
- Steel hammer case
- 5-position power regulator

Part Number	CCN	in	Nm	Nm	rpm	bpm	kg	mm	NPT	mm	l/s	l/s	dB(A)	m/s ² /K ⁽¹⁾
2146Q2MAX	2146Q2MAX	1" □	1,970	270 - 1,360	5,500	1,075	3.60	215	3/8"	13	6.6	18.2	94.3	8.4/3
2171XP	01378165	1" □	1,695	408 - 1,360	6,000	1,025	5.47	226	3/8"	13	4.7	21.50	94.7	10.3/1.3
2171XP-6	16619801	1" □	1,695	408 - 1,360	6,000	1,025	5.95	318	1/2"	13	4.7	21.50	94.7	9.9/3.0
271	01209766	1" □	1,627	136 - 1,017	5,500	1,000	5.67	226	3/8"	13	4.5	17.90	98.1	13.2/1.1

⁽¹⁾ ISO28927 – 3-axis measurement: vibration level/measurement uncertainty.

Performance at 6.2 bar (90 psi)

Air Impacttools™ | 1" (pistol and rear angle)

2175MAX

1" ■ Short anvil(Ring&Thru-hole type)



- Provides maximum torque of 2,715 Nm with a light weight design of only 8.2 kg
- Highly engineered robust motor design maintains power in extreme working conditions
- Chemical resistant housing and solid steel impact mechanism provides reliability and durability

Also available

2175MAX-6

Ring&Thru-hole type (Long anvil 150 mm)

295A

1" ■ Short anvil(Ring&Thru-hole type)



- Designed for operation at 8.3 bar dynamic (120 psi)
- 2,400 Nm
- Swinging-hammer impact mechanism
- 3-position power regulator
- Ring & hole-through anvil

Also available

295A-6

Ring&Thru-hole type (Long anvil 150 mm)

Protection Boot

295-BOOT

CCN: 80159015

290

1" ■ Short anvil (Thru-hole type)



- 2,169 Nm
- Jumbo-hammer impact mechanism

Also available

290-6

Hole through(Long anvil 150 mm)

Part Number	CCN	in	Nm	Nm	rpm	bpm	kg	mm	NPT	mm	l/s	l/s	dB(A)	m/s ² /K ⁽¹⁾
2175MAX	2175MAX	1" □	2,715	2580	4,500	740	8.20	254	1/2"	19	6.7	26.80	101.5	11.8/3.6
2175MAX-6	2175MAX-6	1" □	2,715	2580	4,500	740	9.10	406	1/2"	19	6.7	26.80	101.5	11.2/3.4
295A	80159015	1" □	2,000	136 - 1,220	5,000	700	9.98	290	1/2"	19	5.2	21.70	104.6	15.8/5.2
295A-6	16578734	1" □	2,000	136 - 1,220	5,000	700	11.40	449	1/2"	19	5.2	21.70	104.6	9.1/2.9
290	01173020	1" □	2,169	204 - 1,360	6,000	800	9.93	248	1/2"	19	4.7	26.00	104.6	22.7/2.6
290-6	01181817	1" □	2,169	204 - 1,360	6,000	800	9.93	248	1/2"	19	4.7	28.30	104.6	22.7/2.6

⁽¹⁾ ISO28927 – 3-axis measurement: vibration level/measurement uncertainty.

Performance at 6.2 bar (90 psi)

Air Impacttools™ | Accessories

Sockets Features

Genuine Ingersoll Rand impact sockets are built of top-quality materials for performance and durability. Specifically designed for use with Ingersoll Rand power tools, our sockets are the perfect solution for your everyday tightening and loosening applications.



PowerSocket™

Get up to 50% More Power*

Even when facing the toughest crank bolt or a frozen or rusted lug nut, you won't need to switch to a bigger tool or breaker bar! Because the PowerSocket™ adds the torque you need to your favorite ½" impact wrench. It allows you to remove the most difficult fastener after just a few blows, getting the job done quickly. Thanks to its revolutionary, patent-pending power ring design, PowerSockets™ provide up to 50% more torque*

with your ½" impact wrench. Built to the same standards as our professional-grade impact sockets, they are made to last and work as hard as you.

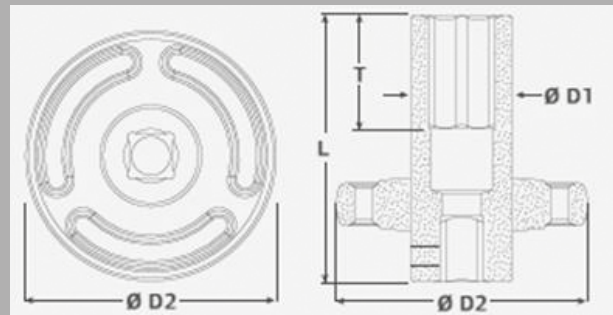

Part Number	CCN	Output Size	Weight kg	D1 mm	D2 mm	T mm	L mm
6-PT PowerSocket™							
S64M17L-PS1	47539801001	17 mm	0.56	30.7	72.6	28.5	78
S64M18L-PS1	47569349001	18 mm	0.56	31.2	72.6	33.7	78
S64M19L-PS1	47539800001	19 mm	0.55	31.4	72.6	34.3	78
S64M21L-PS1	47539802001	21 mm	0.58	34.2	72.6	32.5	78
S64M22L-PS1	47569350001	22 mm	0.64	35.8	72.1	30.3	78
S64M24L-PS1	47569351001	24 mm	0.67	38.2	72.1	30.3	78
S64M26L-PS1	47539803001	26 mm	0.69	39.6	72.1	33.0	78
S64M27L-PS1	47539804001	27 mm	0.71	41.1	72.1	35.7	78
S64H34L-PS1	47569352001	19 mm	0.58	32.4	72.6	33.7	78
S64H78L-PS1	47569353001	22 mm	0.64	36.1	72.1	30.3	78
S64H1516L-PS1	47569354001	24 mm	0.67	38	72.1	30.3	78

SK2M12N

1/4" Square Drive Socket Sets
CCN: 81287336



- 6, 7, 8, 9, 10, 11, 12, 13 and 14 mm, 50 and 100 mm extensions, 3/8"F x 1/4"M adapter

SK3M10N

3/8" Square Drive Socket Sets
CCN: 81287344



- 9, 10, 11, 12, 13, 14, 15, 16, 17 and 19 mm

SK4M14N

1/2" Square Drive Socket Sets
CCN: 80171077



- Contains 14 standard sockets
- 10, 11, 12, 13, 14, 15, 16, 17, 18, 19, 21, 22, 23 and 24 mm

SK4M18N

1/2" Square Drive Socket Sets
CCN: 81287385



- Contains 9 standard sockets
- 10, 11, 13, 14, 17, 19, 21, 22 and 24 mm
- 4 deep sockets
- 13, 14, 21, and 24 mm
- 3 deep/thin wall sockets
- 17, 19 and 21 mm
- 125 mm extension bar and 1/2" square drive power joint

SK4M3LN

1/2" Square Drive Socket Sets
CCN: 81287377



- Contains 3 deep insulated thin wall sockets
- 17, 19 and 21 mm

SK4M7UN

1/2" Square Drive Socket Sets
CCN: 80171093



- 13, 14, 15, 17, 19, 21 and 22 mm
- pre-fitted on power joints – to facilitate handling nuts and bolts in areas with very limited accessibility

SK4M5LN

1/2" Square Drive Socket Sets
CCN: 81287369



- Contains 5 deep sockets
- 17, 19, 21, 22 and 24 mm

SK6M6LN

3/4" Square Drive Socket Sets
CCN: 81287401



- Contains 6 deep sockets
- 24, 27, 30, 32, 33 and 36 mm

SK8M4LN

1" Square Drive Socket Sets
CCN: 81287419



- Contains 4 deep sockets
- 27, 30, 32 and 33 mm

Air Impacttools™ | Accessories

Impact Socket Extensions



	Square drive	Length (mm)	Recommended retaining ring
E24H	1/4"	100	–
E26H	1/4"	150	–
E33H	3/8"	75	RR10003
E36H	3/8"	150	RR10003
E312H	3/8"	300	RR10003
E43H	1/2"	75	RR10006
E45H	1/2"	125	RR10006
E47H	1/2"	175	RR10006
E410H	1/2"	250	RR10006
E424H	1/2"	600	RR10006

	Square drive	Length (mm)	Recommended retaining ring
E63H	3/4"	75	RR10034S
E67H	3/4"	175	RR10034S
E610H	3/4"	250	RR10034S
E83H	1"	75	RR10015S
E87H	1"	175	RR10015S
E810H	1"	250	RR10015S
E813H	1"	330	RR10015S

Universal Joints

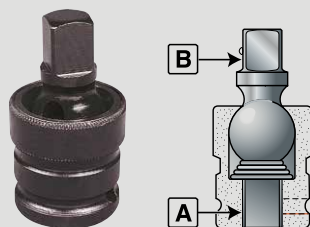

Universal Joint

	A (mm)	B (mm)	Recommended retaining ring
J2	1/4"	1/4"	–
J3	3/8"	3/8"	–
J4	1/2"	1/2"	–
J6	3/4"	3/4"	RR10034S
J8	1"	1"	RR10015S

Adapters

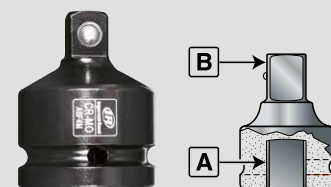

	A (mm)	B (mm)	Recommended retaining ring
A2F3M	1/4"	3/8"	–
A3F2M	3/8"	1/4"	RR10003
A3F4M	3/8"	1/2"	RR10003
A4F3M	1/2"	3/8"	RR10006
A4F6M	1/2"	3/4"	RR10008
A6F4M	3/4"	1/2"	RR10034S
A6F8M	3/4"	1"	RR10034S
A8F6M	1"	3/4"	RR10015S

Air Impacttools™ | Service kits

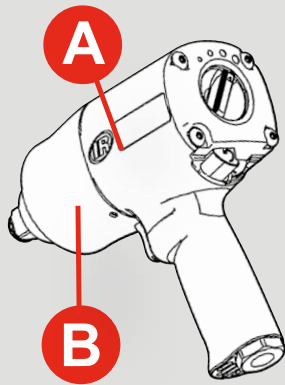

A: Tune-up kit
B: Hammer mechanism kit

	A	B
1/4" and 3/8"	CCN	CCN
1105MAX-D2	45668456	45668522
105-D2	45668142	45668522
2115QTIMAX	45585189	45585932
15QMAX	4762155001	47562154001
212	03866522	—
211	03866449	—
LA158	49827108	49827090
109XPA	16594160	16594384
107XPA	80146491	16590416
1207MAX-D3	47085931	47086368
1105MAX-D3	45668456	45668563
105-D3	45668142	45668563
1/2"	CCN	CCN
35MAX	4762155001	47562154001
2135QXPA	45535028	80119571
2135QXPA-2	45535028	80119662
2235QXPA	47517401001	47517319001
2235QTIMAX	47517401001	47517319001
2235QTIMAX-2	47517401001	47517319001
2130XP	80142375	80140528
1099XPA	16594160	16594392
1077XPA	80146491	16590424
1770	—	80147077
2125QTIMAX	45585189	45585932
2025MAX	47100474	47100359

	A	B
3/4"	CCN	CCN
2145QiMAX	47100011	47102561
2145QiMAX-3	47100011	47102561
2145QiMAX-6	47100011	47102561
2161XP	01372085	—
2161XP-6	04621744	—
261	03866597	22039259
261-3	03866597	—
261-6	03866597	—
259	45663796	45663853
1" pistol	CCN	CCN
295A	16590242	—
295A-6	16590242	—
2155QiMAX	47100011	47102561
2171XP	04621744	80137698
2171XP-6	04621744	80137714
271	03866597	—
1" rear handle	CCN	CCN
631L	45766789	—
2190Ti	80137383	80137698
2190Ti-6	80137383	80137714
2190DTi-6	80137383	80137714
280-EU	03866605	—
280-6-EU	03866605	—
285B	16578965	—
285B-6	16578965	—

DXS Drive Xchange System



The patented DXS® Drive Xchange System™ is a system of impact wrench tools and interchangeable drive accessories that let you configure the tool for the job at hand – no adapters needed.



Never Lose Power

The DXS® system features torque that works smarter, not harder. Tight-fitting DXS® attachments deliver up to 15% more motor torque to fasteners¹, making the tools more effective – so you never lose power.

Frustration-Free Productivity

Save space in your toolkit with the right tool for every time and place. Fast-swapping DXS® accessories let you configure the tool for the job at hand.

Get The Most Out Of Your Investment

Increase your time in service and save replacement costs by simply switching out worn or broken drives to get the tool working like new.

DXS Drive Xchange System | Anvils & Sockets

DXS® uses a proprietary spline-type interface that fits tighter and has more load bearing surface than a traditional square drive. 10 different interchangeable drives swap out quickly, so you save time and stay in service. Simply switch out anvils and sockets to the needed drive size and length – no adapters necessary!



Drive Xchange Guide

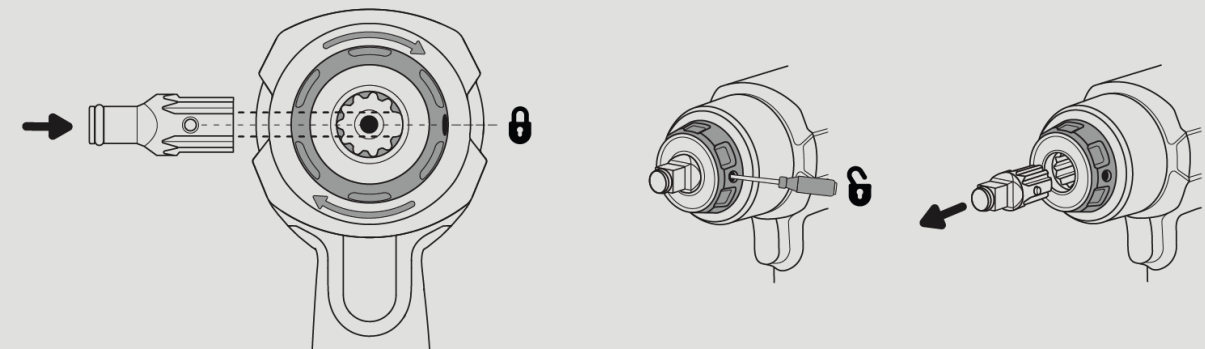

DXS Drive Xchange System | Anvils & Sockets

The patented DXS® **Drive Xchange System™** is a system of impact wrench tools and interchangeable drive accessories that let you configure the tool for the job at hand – no adapters needed.

Compatible with all DXS2 Tool



Drive Xchange Anvil

DXSK2M15

A31H	3/8" Standard Ring	
A41H	1/2" Standard Ring	
AP41H	1/2" Standard Pin	
EA42H	1/2" x 2" Ext. Ring	
EA44H	1/2" x 4" Ext. Ring	
EA46H	1/2" x 6" Ext. Ring	
EA48H	1/2" x 8" Ext. Ring	
EA410H	1/2" x 10" Ext. Ring	
A61H	3/4" Standard Ring	
EA66H	3/4" x 6" Ext. Ring	

Drive Xchange Anvil Kits

AK32H

Set of Two: 3/8", 1/2"



AK62H

Set of Two: 1/2", 3/4"



AK33H

Set of Three : 3/8", 1/2", 3/4"



EAK44H

Set of Four: 1/2" x 4", 1/2" x 6", 1/2" x 8", 1/2" x 10"



AK42H

Set of Two: 1/2" x 2", 3/4"



AK43H

Set of Three: 3/4", 1/2" x 2", 1/2" x 4"



EAK62H

Set of Two: 3/4", 3/4" x 6"



DXS Drive Xchange System | Anvils & Sockets

The patented DXS® Drive Xchange System™ is a system of impact wrench tools and interchangeable drive accessories that let you configure the tool for the job at hand – no adapters needed.

Compatible with all DXS2 Tool Drive Xchange Impact Sockets

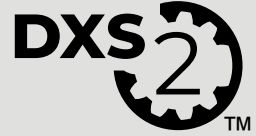

DXSK2M15

DXS Metric Sockets 15 pcs Kit

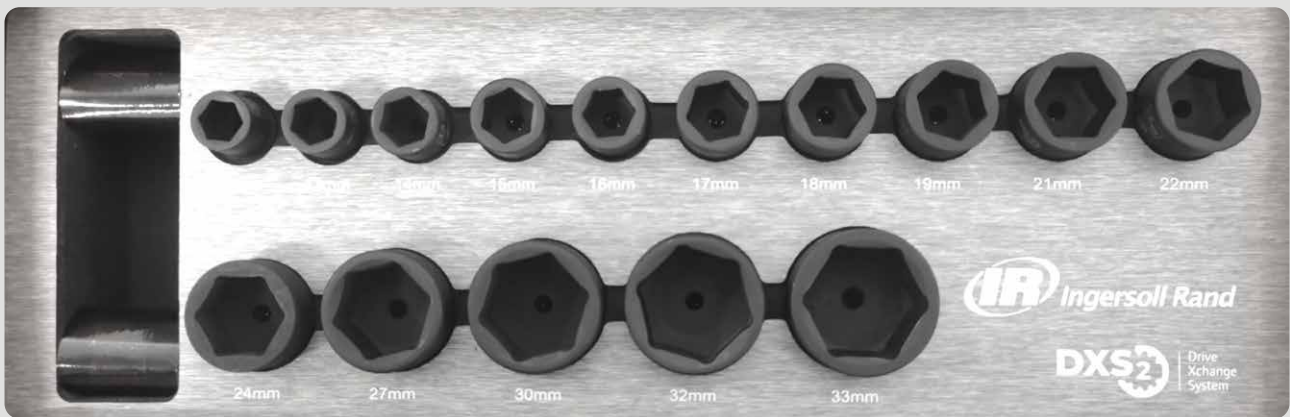

DXS Impact Sockets

POWER

- Up to 15% better torque transfer from tool to bolt*Tool – free Installa-

tion

ACCESS

- Up to 3/4" shorter overall tool and socket length*

**Compared to Ingersoll Rand® 1/2" traditional square drive sockets*

DXSK2M15L

DXS Metric Extended Sockets 15 pcs Kit





**Getting torque even to those
hard to reach bolts – Ingersoll
Rand Air Ratchets take the
hassle out of your job.**



Air Ratchets

50 | 1/4" 3/8" 1/2"

51 | 1/4" 3/8" 1/2"

When Mies van der Rijn has a job to do, he wants to get it done. Loosening and tightening nuts and bolts has to feel natural to him, even in the most remote nook or corner. With the excellent ergonomic and versatility of Ingersoll Rand's compact ratchets, he has found a forceful partner for life.

Mies van der Rijn, Rotterdam

Air Ratchets



1105MAX-D3

3/8" ■



- 41 Nm and 300 rpm
- Only 0.65 kg and 187 mm
- Composite housing
- Power regulator
- Variable speed lever

Also available **1105MAX-D2** 1/4"
Protection Boot **103-BOOT** CCN: 45649035

1207MAX-D4

1/2" ■



- 88 Nm and 200 rpm
- Composite housing
- Power regulator
- Variable speed lever
- 360° adjustable exhaust

Also available **1207MAX-D3** 3/8"

1211MAX-D4

1/2" ■



- 89 Nm and 625 rpm
- Composite housing
- Reactionless twin hammer impact mechanism
- Power regulator
- 360° Swivel Air Inlet

Also available **1211MAX-D3** 3/8"

Part Number	CCN	in	Nm	Nm	rpm	kg	mm	NPT	mm	l/s	l/s	dB(A)	m/s ² /K ⁽¹⁾
1105MAX-D3	45649480	3/8" □	41	7 - 34	300	0.65	187	1/4"	10	1.65	9.43	88.9	5.7/1.0
1105MAX-D2	45649035	1/4" □	41	7 - 34	300	0.65	187	1/4"	10	1.65	9.43	88.9	5.7/1.0
1207MAX-D4	45654225	1/2" □	88	14 - 81	200	1.45	275	1/4"	10	1.88	10.85	85.0	3.2/1.1
1207MAX-D3	4565327-A6	3/8" □	88	14 - 81	200	1.45	275	1/4"	10	1.88	10.85	85.0	3.2/1.1
1211MAX-D3	1211MAX-D3	3/8" □	89	14 - 81	625	1.38	302	1/4"	10	1.9	6.5	91.1	12.7/2.6
1211MAX-D4	1211MAX-D4	1/2" □	89	14 - 81	625	1.38	302	1/4"	10	1.9	6.5	92.1	12.7/2.6

⁽¹⁾ ISO28927 – 3-axis measurement: vibration level/measurement uncertainty.

Performance at 6.2 bar (90 psi)

Air Ratchets

1077XPA

1/2" ■



- 73 Nm and 160 rpm
- Variable speed lever
- 360° adjustable exhaust

Also available

107XPA

3/8"

Protection Boot

107-BOOT

CCN: 80171853

1099XPA

1/2" ■



- 103 Nm and 220 rpm
- Variable speed lever
- 360° adjustable exhaust

Also available

109XPA

3/8"

Protection Boot

109-BOOT

CCN: 80181001

1770

1/2" ■



- 81 Nm of maximum torque
- Heat-treated head provides exceptional durability
- Variable speed lever allows precise delivery of power

Also available

170

3/8"

105-D3

3/8" ■



- 34 Nm and 250 rpm
- Only 0.64 kg and 186 mm
- Variable speed lever

Also available

105-D2

1/4"

105-C3

3/8" (Different gear holder & rotor to 105-D3)

105-L2

1/4"

Protection Boot

103-BOOT

CCN: 45649571

Part Number	CCN	in	Nm	Nm	rpm	kg	mm	NPT	mm	l/s	l/s	dB(A)	m/s ² /K ⁽¹⁾
1077XPA	80171853	1/2" □	68	14 - 61	160	1.10	279	1/4"	10	1.42	8.50	94.4	<2.5
107XPA	80171705	3/8" □	68	14 - 61	160	1.10	279	1/4"	10	1.42	8.50	94.4	<2.5
1099XPA	80181001	1/2" □	103	14 - 87	220	1.40	302	1/4"	10	1.88	11.33	92.4	2.5/0.7
109XPA	16578700	3/8" □	95	14 - 87	220	1.40	302	1/4"	10	1.88	11.33	92.4	2.5/0.7
1770	80103799	1/2" □	81	81	160	1.17	262	1/4"	10	1.90	10.00	94.8	2.8/0.7
170	80103781	3/8" □	81	81	160	1.16	262	1/4"	10	1.90	10.00	94.8	2.8/0.7
105-D3	45649738	3/8" □	34	7 - 27	250	0.64	186	1/4"	10	1.42	8.50	81.8	5.1/0.9
105-D2	45649571	1/4" □	34	7 - 27	250	0.64	186	1/4"	10	1.42	8.50	81.8	5.1/0.9
105-C3	45662293	3/8" □	34	7 - 27	250	0.64	186	1/4"	10	1.42	8.50	81.8	3.5/1.2
105-L2	45650660	1/4" □	34	7 - 27	250	0.71	214	1/4"	10	1.42	8.50	81.8	3.7/0.9

(1) ISO28927 – 3-axis measurement: vibration level/measurement uncertainty.

Performance at 6.2 bar (90 psi)



Impressive performance and ultimate precision – The throttle of Ingersoll Rand air grinders really puts you in the driver's seat.



Air Grinders

54 | Die Grinders

57 | Wheel Grinders

With the sheer power a grinder needs, control is of the essence for Tomasz Głacz. Because he always aims for maximum precision.

Working with a compact, lightweight Ingersoll Rand grinder, he hasn't only come to love the handling but also is a good deal more efficient.

Tomasz Głacz, Krakow

Air Grinders



5102MAX

Angle



- 0.30 kW(0.40 HP)
- 20,000 rpm
- Only 0.64 kg and 178 mm
- Composite housing
- Contains: 1/4" collet
- Rear exhaust

Also available

5102MAX-M

Contains: 6 mm collet

5104MAX

Contains: 1/4" collet

5104MAX-M

Contains: 6 mm collet

5108MAX

Straight



- 0.30 kW(0.40 HP)
- 25,000 rpm
- Only 0.46 kg and 167 mm
- Composite housing
- Contains: 1/4" collet
- Rear exhaust

Also available

5108MAX-M

Contains: 6 mm collet

5106MAX

Contains: 1/4" collet

5106MAX-M

Contains: 6 mm collet

5107MAX

Contains: 6 mm collet

5107MAX-M

Contains: 6 mm collet

5208MAX

Extended Straight



- 0.30 kW(0.40 HP)
- 25,000 rpm
- Only 0.64 kg and 244 mm
- Composite housing
- Contains: 1/4" collet
- Rear exhaust

Also available

5208MAX-M

Contains: 6 mm collet

Part Number	CCN	mm	kWatt	$\frac{1}{\text{min}}$ rpm	kg	mm	NPT	mm	l/s	l/s MAX	dB(A)	$\text{m/s}^2/\text{K}^{(1)}$
5102MAX	48488357	1/4"	0.3	20,000	0.64	179	1/4"	10	2.8	11.80	84.0	3.3/1.1
5102MAX-M	5102MAX-M	6	0.3	20,000	0.64	179	1/4"	10	2.8	11.80	84.0	3.3/1.1
5104MAX	5104MAX	1/4"	0.3	12,000	0.64	178	1/4"	10	2.8	11.8	85.6	4.0/1.0
5104MAX-M	5104MAX-M	6	0.3	12,000	0.64	178	1/4"	10	2.8	11.8	85.6	4.0/1.0
5106MAX	5106MAX	1/4"	0.3	35,000	0.46	167	1/4"	10	2.8	11.8	82.6	2.6/1.5
5106MAX-M	5106MAX-M	6	0.3	35,000	0.46	167	1/4"	10	2.8	11.8	82.6	2.6/1.5
5107MAX	5107MAX	1/4"	0.3	30,000	0.46	167	1/4"	10	2.8	11.8	81.6	3.5/1.4
5107MAX-M	5107MAX-M	6	0.3	30,000	0.46	167	1/4"	10	2.8	11.8	81.6	3.5/1.4
5108MAX	48488340	6	0.3	25,000	0.46	167	1/4"	10	2.8	11.80	83.3	1.8/0.8
5108MAX-M	5108MAX-M	1/4"	0.3	25,000	0.46	167	1/4"	10	2.8	11.80	83.3	1.8/0.8
5208MAX	5208MAX	1/4"	0.3	25,000	0.64	244	1/4"	10	2.8	11.8	85.5	3.0/0.4
5208MAX-M	5208MAX-M	6	0.3	25,000	0.64	244	1/4"	10	2.8	11.8	85.5	3.0/0.4

(1) ISO28927 – 3-axis measurement: vibration level/measurement uncertainty.

Performance at 6.2 bar (90 psi)

Air Grinders | Die Grinders

302B Straight



- 0.25 kW (0.33 HP)
- 20,000 rpm
- Only 0.58 kg and 175 mm
- Contains: 1/4" collet
- Rear exhaust

Also available

302B-M

Contains: 6 mm collet

Available in Kits

302BK Die Grinder Kit
CCN: 48488282



Includes: 2" & 3" quick change backing pads, 2" & 3" quick change sanding disks, 2" & 3" quick change coarse and medium polishing disks

308B Angle



- 0.25 kW (0.33 HP)
- 25,000 rpm
- Only 0.46 kg and 172 mm
- Contains: 1/4" collet
- Rear exhaust

Also available

308B-M

Contains: 6 mm collet

Available in Kits

308BK Die Grinder Kit
CCN: 48488290



Includes: Carbide burrs set & 2 wrenches

307B Straight



- 0.19 kW (0.25 HP)
- 28,000 rpm
- Only 0.33 kg and 125 mm
- Contains: 1/4" collet
- Front exhaust

Also available

307B-M

Contains: 6 mm collet

Available in Kits

307BK Die Grinder Kit
CCN: 48488274



Includes: 10 mounted grinding tips

Part Number	CCN	mm	kWatt	$\frac{1}{\text{min}}$	kg	mm	NPT	mm	l/s	l/s MAX	dB(A)	$\text{m/s}^2/\text{K}^{(1)}$
302B	48488365	1/4"	0.25	20,000	0.58	176	1/4"	10	2.8	10.90	90.0	5.5/1.5
302B-M	302B-M	6	0.25	20,000	0.58	176	1/4"	10	2.8	10.90	90.0	5.5/1.5
308B	48488332	1/4"	0.25	25,000	0.46	174	1/4"	10	3.3	13.20	92.0	3.7/1.2
308B-M	308B-M	6	0.25	25,000	0.46	174	1/4"	10	3.3	13.20	92.0	3.7/1.2
307B	48488316	1/4"	0.19	28,000	0.33	132	1/4"	10	2.8	11.30	83.0	4.5/1.1
307B-M	307B-M	6	0.19	28,000	0.33	132	1/4"	10	2.8	11.30	83.0	4.5/1.1

⁽¹⁾ ISO28927 – 3-axis measurement: vibration level/measurement uncertainty.

Performance at 6.2 bar (90 psi)

Air Grinders | Die Grinders

301B

Angle



- 0.19 kW (0.25 HP)
- 21,000 rpm
- Only 0.46 kg and 128 mm
- Contains: 1/4" collet
- Front exhaust

Also available

301B-M

Contains: 6 mm collet

Available in Kit

301B2MK Surface conditioning Kit
CCN: :48488233



Includes: 4 coarse & 4 medium grit 2" Roloc™ surface conditioning pads, a disk holder

301B3MK Surface conditioning Kit

CCN: 48488258



Includes: 4 coarse & 4 medium grit 3" Roloc™ surface conditioning pads

301B32MK Surface conditioning Kit
CCN: 48488241



Includes: 2 coarse & 2 medium grit 3" Roloc surface conditioning pads, 2 coarse & 2 medium grit 2" Roloc surface conditioning pads, 2 disk holders

301BK Die Grinder Kit

CCN: 48488266



Includes: 10 mounted grinding tips

409

Straight



- 0.37 kW (0.50 HP)
- 27,000 rpm
- Only 0.54 kg and 149 mm
- Contains: 1/4" and 6 mm collets
- Front exhaust

LA429-EU

Straight



- 0.42 kW (0.56 HP)
- 20,000 rpm
- Only 0.54 kg
- Contains: 1/4" and 6 mm collets

Replacement collets



Part Number	CCN	diameter
Collets for 301B, 302B, 307B, 308B, 5102MAX, 5108MAX and LA429-EU		
301-700C	80128952	Ø 1/8"
301-700B	04552600	Ø 6 mm
301-700	80102346	Ø 1/4"

Part Number	CCN	mm	kWatt	rpm	kg	mm	NPT	mm	l/s	l/s	dB(A)	m/s ² /K ⁽¹⁾
301B	48488308	1/4"	0.19	21,000	0.46	134	1/4"	10	2.8	11.30	92.0	5.9/1.0
301B-M	301B-M	6	0.19	21,000	0.46	134	1/4"	10	2.8	11.30	92.0	5.9/1.0
409	47498324001	4	0.37	27,000	0.54	149	1/4"	10	-	-	91.0	6.4/3.5
LA429-EU	01328558	6	0.42	22,000	0.54	142	1/4"	10	1.8	9.00	91.0	3.2/1.7

⁽¹⁾ ISO28927 – 3-axis measurement: vibration level/measurement uncertainty.

Performance at 6.2 bar (90 psi)

Air Grinders | Wheel Grinders

3445MAX

115 mm (4.5")



- 0.66 kW (0.88 HP)
- 12,000 rpm
- Internal governor
- Enhanced grip design
- Built-in lubricating wick
- Piped-away exhaust kit

Also available

- 344MAX**
100 mm (4")
- 3445MAX-M**
115 mm (4.5")
- 345MAX**
125 mm (5")
- 345MAX-M**
125 mm (5")

5445MAX

115 mm (4.5")



- 1.86 kW (2.5 HP)
- 12,000 rpm
- Governed motor
- Low profile throttle lever and ergonomic grip
- Tool-free adjustable guard and spindle lock
- Piped-away exhaust kit

Also available

- 5445MAX-M**
115 mm (4.5")
- 545MAX**
125 mm (5")
- 545MAX-M**
125 mm (5")

4445

115 mm (4.5")



- 0.67 kW (0.9 HP)
- 14,000 rpm
- Extended angel head with reduced height
- Slim grip and low-profile throttle lever
- Adjustable swivel guard and spindle lock

Also available

- 444**
100 mm (4")
- 445**
127 mm (5")

LA422B-EU

125 mm (5")



- 0.50 kW (0.68 HP)
- 12,000 rpm

Also available

- LA421B-EU**
100 mm (4")

Part Number	CCN	mm	mm	kWatt	1 min rpm	kg	mm	NPT	mm	l/s	l/s	dB(A)	m/s ² /K ⁽¹⁾
344MAX	344MAX	100	3/8" - 24	0.66	12,000	1.5	244	1/4"	10	4.7	19.3	79.6	7.9/2.5
3445MAX	45664224	115	5/8" - 11	0.66	12,000	1.50	245	1/4"	10	4.7	19.3	79.6	6.3/2.2
3445MAX-M	45664240	115	M14	0.66	12,000	1.50	245	1/4"	10	4.7	19.3	79.6	6.3/2.2
345MAX	45664232	127	5/8" - 11	0.66	12,000	1.60	245	1/4"	10	4.7	19.3	79.6	7.9/2.5
345MAX-M	45664257	127	M14	0.66	12,000	1.60	245	1/4"	10	4.7	19.3	79.6	7.9/2.5
5445MAX	5445MAX	115	5/8" - 11	1.86	12,000	1.86	237	3/8"	13	15.3	36.2	95.1	8.4/1.3
5445MAX-M	5445MAX-M	115	M14	1.86	12,000	1.86	237	3/8"	13	15.3	36.2	91.8	8.4/1.3
545MAX	545MAX	127	5/8"-11	1.86	12,000	1.87	237	3/8"	13	15.3	36.2	95.1	8.4/1.3
545MAX-M	545MAX-M	127	M14	1.86	12,000	1.87	237	3/8"	13	15.3	36.2	91.8	8.4/1.3
444	444	100	3/8" - 24	0.67	14,000	1.65	268	1/4"	10	16.0	13.7	92.2	6.9/1.2
4445	4445	115	5/8" - 11	0.67	12,000	1.65	268	1/4"	10	15.1	13.0	89	5.7/1.2
445	445	127	5/8" - 11	0.67	12,000	1.65	268	1/4"	10	15.1	13.0	89	5.9/1.4
LA422B-EU	LA422B-EU	125	3/8" - 24	0.5	12,000	1.75	229	1/4"	10	2.8	10.4	85.6	6.0/2.1
LA421B-EU	LA421B-EU	100	3/8" - 24	0.5	12,000	1.75	229	1/4"	10	2.8	10.4	85.6	4.8/1.4

⁽¹⁾ ISO28927 – 3-axis measurement: vibration level/measurement uncertainty.

Performance at 6.2 bar (90 psi)



For all to whom finishing is an art form – Ingersoll Rand gives you perfect grip and the perfect tool, for whatever purpose.

Air Finishing tools

60 | Air Sanders and Polishers

65 | Belt Sander & Engraving Pen & Pencil Grinder

66 | Pads, Disks and Bonnets

For Mustafa Belkhoda, perfect body work starts with a perfect finish. Smooth, swirl free surfaces are an accomplishment he prides himself on. Ingersoll Rand's sanders fit his hand like a glove, giving his work a sophistication that leaves him with a proud smile at the end of every day.

Mustafa Belkhoda, Chartres

Air Finishing tools



5151-5

RO sander

127 mm (5"), orbit 5 mm (3/16")



Also available

5151-5-HL

127mm (5"), orbit 5mm (3/16")

5152-5

127mm (5"), orbit 2.5mm (3/32")

5152-5-HL

127mm (5"), orbit 2.5mm (3/32")

5151-6

152mm (6"), orbit 5mm (3/16")

5151-6-HL

152mm (6"), orbit 5mm (3/16")

5152-6

152mm (6"), orbit 2.5 mm (3/32")

5152-6-HL

152mm (6"), orbit 2.5 mm (3/32")

Part Number	CCN	mm	mm	mm	kWatt	$\frac{1}{\text{min}}$	kg	mm	NPT	mm	l/s	l/s	dB(A)	m/s ² /K ⁽¹⁾
5151-5	5151-5	127	5	5/16" - 24	0.22	12,000	0.82	166	1/4"	8	8.3	-	77.9	10.1/3.3
5151-5-HL	5151-5-HL	127	5	5/16" - 24	0.22	12,000	0.82	166	1/4"	8	8.3	-	77.9	9.5/3.1
5152-5	5152-5	127	2.5	5/16" - 24	0.22	12,000	0.82	166	1/4"	8	8.3	-	77.9	6.0/2.0
5152-5-HL	5152-5-HL	127	2.5	5/16" - 24	0.22	12,000	0.82	166	1/4"	8	8.3	-	77.9	2.8/0.9
5151-6	5151-6	152	5	5/16" - 24	0.22	12,000	0.82	166	1/4"	8	8.3	-	77.9	8.8/2.9
5151-6-HL	5151-6-HL	152	5	5/16" - 24	0.22	12,000	0.82	166	1/4"	8	8.3	-	77.9	6.0/2.0
5152-6	5152-6	152	2.5	5/16" - 24	0.22	12,000	0.82	166	1/4"	8	8.3	-	77.9	5.2/1.7
5152-6-HL	5152-6-HL	152	2.5	5/16" - 24	0.22	12,000	0.82	166	1/4"	8	8.3	-	77.9	4.4/1.5

⁽¹⁾ ISO28927 – 3-axis measurement: vibration level/measurement uncertainty.

Performance at 6.2 bar (90 psi)

Air Finishing tools | Air Sanders and Polishers

4151-5

RO sander
127 mm (5"), orbit 5 mm (3/16")



- 0.15 kW (0.20 HP)
- 12,000 rpm
- Only 0.87 kg
- Composite housing
- Auto-balancer
- Vacuum Ready

Also available

- 4151**
152 mm (6"), orbit 5 mm (3/16")
- 4151-2**
152 mm (6"), orbit 5 mm (3/16")
- 4152**
152 mm (6"), orbit 2.5 mm (3/32")
- 4151-HL**
152 mm (6"), orbit 5 mm (3/16")
- 4151-HL-2**
152 mm (6"), orbit 5 mm (3/16")
- 4152-HL**
152 mm (6"), orbit 2.5 mm (3/32")
- 4152-HL-SR**
75 mm (3"), orbit 2.5 mm (3/32")

311A

RO sander
152 mm (6"), orbit 5 mm (3/16")



- 0.19 kW (0.25 HP)
- 12,000 rpm
- Power Regulator

Part Number	CCN	mm	mm	mm	kWatt	$\frac{1}{\text{min}}$	kg	mm	NPT	mm	l/s	l/s	dB(A)	$\text{m/s}^2/\text{K}^{(1)}$
4151-5	01371681	127	5	5/16" - 24	0.15	12,000	0.87	178	1/4"	8	3.7	7.20	81.6	6.2/1.0
4151	01365311	152	5	5/16" - 24	0.15	12,000	0.87	190	1/4"	8	3.7	7.20	81.6	7.5/1.6
4151-2	22041917	152	5	5/16" - 24	0.15	12,000	1.12	252	1/4"	8	3.7	7.20	81.6	6.2/1.0
4152	80132269	152	2.5	5/16" - 24	0.15	12,000	0.87	190	1/4"	8	3.7	7.20	81.6	8.2/1.7
4151-HL	01371624	152	5	5/16" - 24	0.15	12,000	0.87	190	1/4"	8	3.7	7.20	81.6	7.0/2.2
4151-HL-2	22041198	152	5	5/16" - 24	0.15	12,000	1.12	252	1/4"	8	3.7	7.20	81.6	6.2/1.0
4152-HL	80134356	152	2.5	5/16" - 24	0.15	12,000	0.87	190	1/4"	8	3.7	7.20	81.6	7.0/2.2
4152-HL-SR	16674301	75	2.5	5/16" - 24	0.15	12,000	0.84	155	1/4"	8	3.7	7.20	81.6	4.7/1.3
311A	01365253	152	5	-	0.19	12,000	1.91	248	1/4"	10	-	8.00	85.6	32.3/5.6

⁽¹⁾ ISO28927 – 3-axis measurement: vibration level/measurement uncertainty.

Performance at 6.2 bar (90 psi)

Air Finishing tools | Air Sanders and Polishers

313-B
Sander



- 178 mm (7")
- 0.37 kW (0.5 HP)
- 5,000 rpm

Also available

314-B
3,000 rpm

317-B
Sander



- 75 mm and 125 mm
- 0.35 kW (0.45 HP)
- 18,000 rpm

318-B
Polisher



- 178 mm (7")
- 0.6 kW (0.8 HP)
- 2,000 rpm

Also available

319-B
5,000 rpm

Part Number	CCN	mm	mm	mm	kWatt	1 min rpm	kg	L mm	NPT	mm	l/s	l/s	dB(A)	m/s ² /K ⁽¹⁾
313-B	80141021	178	5/8" - 11		0.37	5,000	2.12	310	1/4"	10	3.5	-	94.3	2.0
314-B	80141039	178	5/8" - 11		0.37	3,000	2.12	310	1/4"	10	3.2	-	91.3	4.7
317-B	80090863	75/125	7/16" - 20		0.35	18,000	0.91	119	1/4"	10	7.0	-	94.0	3.2/0.8
318-B	80141047	178	5/8" - 11		0.76	2,000	2.04	239	1/4"	10	3.2	-	84.0	2.2
319-B	80141054	178	5/8" - 11		0.76	5,000	2.18	239	1/4"	10	3.3	-	90.0	2.4

⁽¹⁾ ISO28927 – 3-axis measurement: vibration level/measurement uncertainty.

Performance at 6.2 bar (90 psi)

Air Finishing tools | Air Sanders and Polishers

3103XPA

Sander



- 50 mm (2") and 75 mm (3")
- 0.15 kW (0.2 HP)
- 15,000 rpm
- Only 0.50 kg and 135 mm
- Composite housing
- 2-position power regulator

Available in kits

3103KA Kit

CCN: 47520769001



Includes 14-piece 2" (50mm) and 3" (75mm) sanding discs and pads

3128XPA

RO sander



- 75 mm (3")
- Orbit 5 mm (3/16")
- 0.15 kW (0.2 HP)
- 15,000 rpm
- Only 0.60 kg and 145 mm
- Composite housing
- 2 -position power regulator

Available in kits

3128KA Kit

CCN: 47520770001



Includes 71-piece hook and loop discs and pad:
- 180, 220, 320 and 800 grits aluminum oxide
- backing pad

3129XPA

Polisher



- 75 mm (3")
- 0.22 kW (0.30 HP)
- 6,400 rpm
- Only 0.60 kg and 155 mm
- Composite housing
- 2-position power regulator

Available in kits

3129KA Kit

CCN: 47520771001



Includes four-piece hook and loop pads with foams

Part Number	CCN	mm	mm	kWatt	rpm	kg	mm	NPT	mm	l/s	dB(A)	m/s ² /K ⁽¹⁾
3103XPA	47520748001	50 and 75	-	0.15	15,000	0.50	135	1/4"	10	9.0	78.6	4.1/0.8
3128XPA	47520749001	75	5.00	0.15	15,000	0.60	145	1/4"	10	8.6	80.9	5.2/1.1
3129XPA	47520750001	75	-	0.22	6,400	0.60	155	1/4"	10	9.4	81.5	2.7/0.7

⁽¹⁾ ISO28927 – 3-axis measurement: vibration level/measurement uncertainty.

Performance at 6.2 bar (90 psi)

Air Finishing tools | Air Sanders and Polishers

327-A
Buffer



- 0.37 kW (0.5 HP)
- 23,000 rpm
- Lever throttle
- Rear exhaust

312A
Sander



- 93 x 171 mm (3.67" x 6.75")
- 0.22 kW (0.30 HP)
- 8,000 strokes per minute

315-EU
Sander















- 70mm x 445mm (2.75" x 17.5")
- 3,000 reciprocating strokes per minute
- Quick - action paper clamps
- Smooth, reliable power

327LS-A
Tire buffer



- 0.37 kW (0.5 HP)
- 3,000 rpm
- Only 0.64 kg
- Piped-away exhaust

Part Number	CCN	 mm	 mm	 kW	 rpm	 kg	 mm	 NPT	 mm	 l/s	 l/s	 dB(A)	 m/s ² /K ⁽¹⁾
327-A	327-A	-	3/8"chuck	0.37	23,000	0.82	197	1/4"	10	2.4	-	92.0	1.2
327LS-A	327LS-A	-	7/16"☞	0.37	3,000	0.64	216	1/4"	10	5.9	-	85.0	1.7
312A	80147101	93*171	-	0.22	8,000	2.09	-	1/4"	10	4.25	5.70	94.1	7.7/1.9
315-EU	01343961	70*445	-	-	3,000(strokes/min)	2.99	445	1/4"	10	3.80	4.25	93.3	20.5/1.6

⁽¹⁾ ISO28927 – 3-axis measurement: vibration level/measurement uncertainty.

Performance at 6.2 bar (90 psi)

Air Finishing tools | Belt Sander & Engraving Pen & Pencil Grinder

360-313 & 360-418

Belt sander

10 x 330 mm (3/8" x 13")

13 x 457 mm (1/2" x 18")



- 0.44 kW(0.6HP)
- Tool-free articulating arm
- 60,80,100 grit belt

140EP

Engraving pen

- 11,400 bpm
- Only 0.19 kg
- Rubber grip

320PG

Pencil grinder















- 60,000 rpm
- Only 0.23 kg
- Custom TPU grip

Available in kits

320PGK Kit
CCN: 320PGK



Includes 5 assorted mounted points
and 5 assorted carbide burrs

Part Number	CCN	 mm	 mm	 kW	 rpm	 kg	 mm	 NPT	 mm	 l/s	 l/s	 dB(A)	 m/s ² /K ⁽¹⁾
360-313	360-313	3/8" x 13"	-	0.44	20,000	1.04	316	1/4"	10	13.6	-	90	<2.5
360-418	360-418	1/2" x 18"	-	0.44	20,000	1.09	383	1/4"	10	13.8	-	92	<2.5
140EP	140EP	-	-	-	11,400	0.19	140	1/4"	4	-	0.5	75	<5
320PG	320PG	3	0.07	-	60,000	0.23	140	1/4"	5.5	-	3.7	78	<3.2/0.57

⁽¹⁾ ISO28927 – 3-axis measurement: vibration level/measurement uncertainty.

Performance at 6.2 bar (90 psi)

Air Finishing tools | Pads, Disks and Bonnets

Quick-change pads & abrasives 50 (2") and 75 mm (3")



Part Number	CCN	Description	Qty.
50 mm (2") Diameter			
02A-MEDPD	80199177	Quick-change pad with 1/4" mandrel	1
02A-CRSBR	80199193	Coarse coating removal discs	1
02A-MEDBR	80199185	Medium coating removal discs	1
02A-BBCRS-25	80207574	Quick-strip discs	25
02A-036AO	80199896	Aluminum oxide sanding discs, grit 36	1
02A-036AO	80199201	Aluminum oxide sanding discs, grit 80	1
75 mm (3") Diameter			
03A-MEDPD	80198963	Quick-change pad with 1/4" mandrel	1
03A-CRSBR	80199037	Coarse coating removal discs	1
03A-MEDBR-25	80206220	Medium coating removal discs	25
03A-CRSBB-10	80216690	Quick-strip discs	10
03A-036AO	80200009	Aluminum oxide sanding discs, grit 36	1
03A-080AO5	80199219	Aluminum oxide sanding discs, grit 80	1

Hook-and-loop pad, discs & bonnets 75 mm (3")



Part Number	CCN	Description	Qty.
Backer pad			
03H-PAD-HL	80199136	Backer pad Ø 75 mm (3 in), hook & loop	1
Aluminum oxide sanding discs			
03H-040AO-50	80207582	Grit 40	50
03H-100AO-50	80206279	Grit 100	50
03H-180AO-50	80206295	Grit 180	50
03H-220AO-50	80206303	Grit 220	50
03H-320AO-50	80206329	Grit 320	50
03H-500AO-50	80206352	Grit 500	50
03H-800AO-50	80205404	Grit 800	50
Polishing Bonnets			
03F-SFTWL-6	80206170	Wool bonnet (for compounding)	6
03F-MEDFM-6	80206188	Waffle bonnet/white (for compounding)	6
03F-SFTFM-6	80206196	Waffle bonnet/yellow (for polishing)	6

Accessories for 4151 and 5151



Part Number	CCN	Description
4151JV	04662896	Jet-Vac conversion kit
49988	04324455	Dust collection bags (20 pieces)
49987	04324448	Dust collection bags (250 pieces)
4151-747B	80095151	Rubber grip
4151-2-747BLK	22041941	Rubber grip, long handle
49096-1	04320578	5" Vinyl Pad
VPAD-5HL	47749105001	5" H&L Pad
VPAD-6	80126683	6" Vinyl Pad
VPAD-6HL	80126691	6" H&L Pad

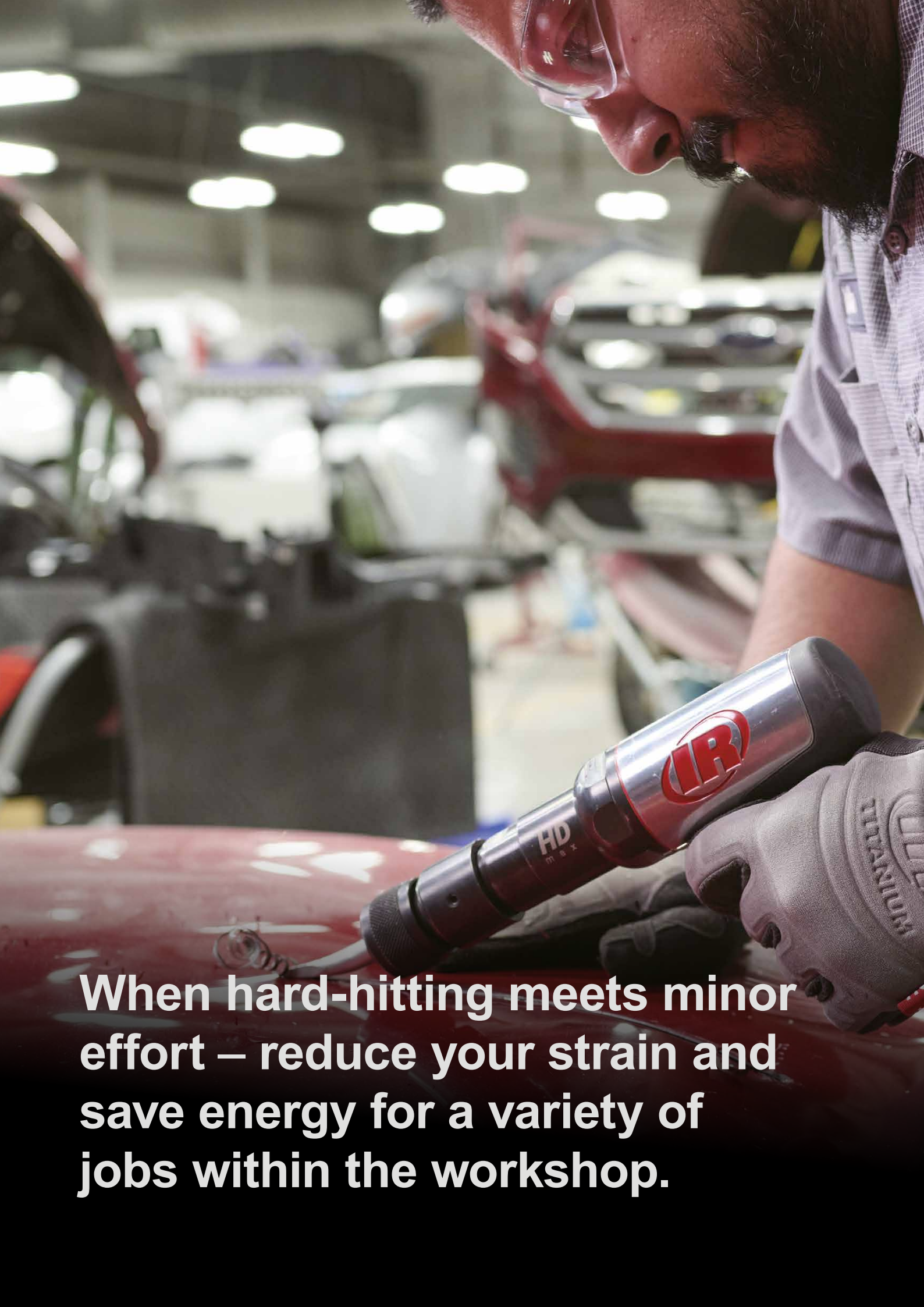

When hard-hitting meets minor effort – reduce your strain and save energy for a variety of jobs within the workshop.



Air Hammers

70 | Round shank

71 | Needle Scaler

Enzo Buonpensa has never cut, punched, chipped, scraped, or worked on exhaust more conveniently and swiftly. The intelligent design of the robust Ingersoll Rand Air Hammer makes it indispensable especially for extended use. That's why the new tool has really paid off quickly for him.

Enzo Buonpensa, Turin

Air Hammers



119MAX

Round shank



- Stroke: 89 mm
- 2,530 blows per minute
- Contains: quick-change retainer

Available in kits

119MAXK

Round shank
CCN: 119MAXK



Hammer + Quick-Change Retainer and 5 Chisels

123MAX

Round shank



- Stroke: 67 mm
- 3,530 blows per minute
- Contains: quick-change retainer

Available in kits

123MAXK

Round shank
CCN: 123MAXK



Hammer + Quick-Change Retainer and 5 Chisels

135MAX

Round shank



- Stroke: 76 mm
- 2,600 blows per minute
- Contains: quick-change retainer

Available in kits

135MAXK

Round shank
CCN: 135MAXK



Hammer + Quick-Change Retainer and 5 Chisels

Part Number	CCN	bpm	mm	kg	mm	NPT	mm	l/s	l/s	dB(A)	m/s ² /K ⁽¹⁾
119MAX	119MAX	2,530	89	2.0	231.9	1/4"	10	-	11.2	95.7	4.5/2.3
123MAX	123MAX	3,530	67	1.8	182.9	1/4"	10	-	11.4	95.0	5.9/4.2
135MAX	135MAX	2,600	76	2.0	220.1	1/4"	10	-	1.3	98.0	5.4/2.9

⁽¹⁾ ISO28927 – 3-axis measurement: vibration level/measurement uncertainty.

Performance at 6.2 bar (90 psi)

Air Hammers | Round shank | Needle Scaler

121-EU

Round shank



- Stroke: 58 mm
- 3,000 blows per minute

Also available

121/Q-EU

Hexagonal shank

115

Round shank



- stroke: 41mm
- 5000 blows per minute

116

Round shank



- Stroke: 67 mm
- 3,500 blows per minute
- Power regulator

Also available

116H

Hexagonal shank

117

Round shank



- Up to 2,000 blows per minute
- Alloyed steel barrel and heat-treated piston for longer life
- Built-in power regulator and trigger control

132

Round shank



- Up to 1,725 blows per minute
- Alloyed steel barrel and heat-treated piston for longer life
- Built-in power regulator and trigger control

125

Needle scaler



- Stroke: 28 mm
- 4,600 blows per minute
- Contains: steel needles

Part Number	CCN	bpm	mm	kg	mm	NPT	mm	l/s	l/s	dB(A)	m/s ² /K ⁽¹⁾
121-EU	04352746	3,000	58	1.59	194	1/4"	10	1.40	7.10	95.3	19.9/4.6
121/Q-EU	01343698	3,000	58	1.59	194	1/4"	10	1.40	7.10	95.3	19.9/4.6
115	01216175	5,000	41	1.18	155	1/4"	10	0.95	6.60	101.3	14.8/2.2
116	01216183	3,500	67	1.54	198	1/4"	10	1.40	7.10	104.4	14.8/2.2
116H	01233501	3,500	67	1.54	198	1/4"	10	1.40	7.10	104.4	14.8/2.2
117	01216191	2,000	89	1.86	251	1/4"	10	1.40	6.60	103.5	9.2/3.0
132	01173525	1,725	102	1.54	216	1/4"	10	1.40	5.20	-	-
125	01348200IRI	46,000	-	2.83	465	1/4"	8	3.80	7.10	96.6	8.3/1.3

⁽¹⁾ ISO28927 – 3-axis measurement: vibration level/measurement uncertainty.

Performance at 6.2 bar (90 psi)

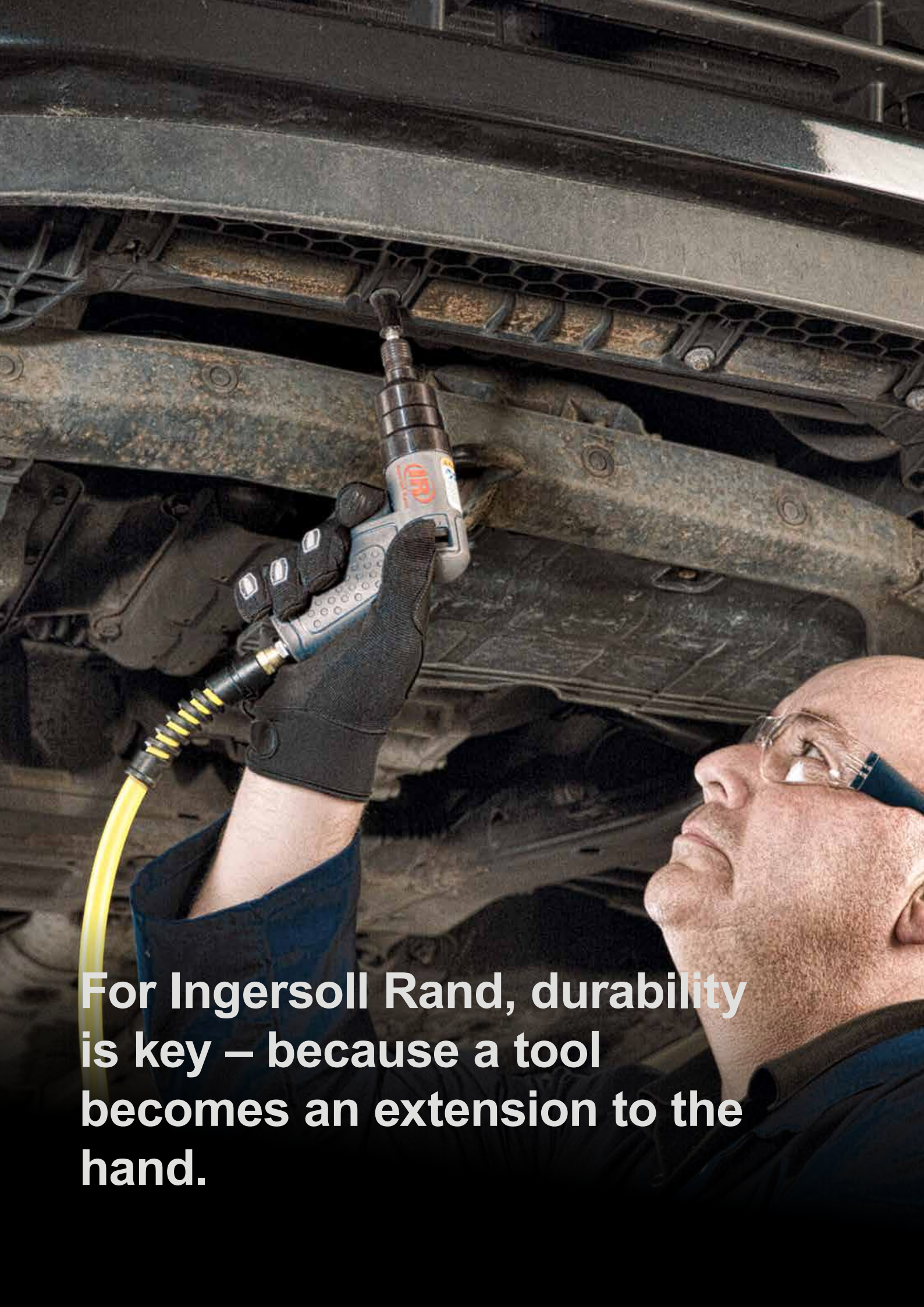

For Ingersoll Rand, durability is key – because a tool becomes an extension to the hand.



Air Drills, Screwdrivers and specialty tools

74 | Drills

76 | Screwdrivers

77 | Specialty Tools (incl. cutting tools)

When the going gets tough, Knut Paulsen gets his toughest tools going. And these are his Ingersoll Rand Air Drills and Screwdrivers. Having counted on them for all purposes for years, he knows a thing or two about them: being virtually indestructible they are in high demand in the shop and best kept in the top shelf right next to him.

Knut Paulsen, Hamburg

Air Drills, Screwdrivers and specialty tools



7804R

Standard chuck, reversible



- 6.5 mm (1/4 in)
- 0.12 kW (0.17 HP)
- 1,600 rpm
- Only 0.8 kg and 180 mm
- Composite housing
- Reversible

Available in kits

7804KA Standard chuck, reversible

CCN: 47520772001



Includes 22-piece drill bit and driver set

Part Number	CCN	SIZE mm	kWatt kW	$\frac{1}{\text{min}}$ rpm	 kg	 mm	 NPT	 mm	 l/s	 l/s	 dB(A)	 m/s ² /K ⁽¹⁾
7804R	01319185	10	0.19	1,200	0.80	193	1/4"	10	0.9	7.65	88.4	<2.5

⁽¹⁾ ISO28927 – 3-axis measurement: vibration level/measurement uncertainty.

Performance at 6.2 bar (90 psi)

Air Drills, Screwdrivers and specialty tools | Drills

7803A

Standard chuck



- 13 mm (1/2 in) chuck
- 0.37 kW (0.50 HP)
- 500 rpm

Also available

7803AKC

Keyless chuck

7803RA

Standard chuck, reversible

7803RAKC

Keyless chuck, reversible

Protection Boot

7803-BOOT

CCN: 80113632

7802A

Standard chuck



- 10 mm (3/8 in) chuck
- 0.37 kW (0.50 HP)
- 2,000 rpm

Also available

7802AKC

Keyless chuck

7802RA

Standard chuck, reversible

7802RAKC

Keyless chuck, reversible

Protection Boot

7802-BOOT

CCN: 80113616

7807R-A

Standard chuck, reversible



- 10 mm (3/8 in) standard chuck
- 0.25 kW (0.33 HP)
- 1,800 rpm
- Reversible

LA410-EU

Standard chuck



- 10 mm (3/8 in) standard chuck
- 0.25 kW (0.33 HP)
- 4,500 rpm

Part Number	CCN	SIZE	kWatt	$\frac{1}{\text{min}}$	kg	L	NPT	mm	l/s	l/s	dB(A)	m/s ² /K ⁽¹⁾
		mm	kW	rpm								
7803A	80113632	13	0.37	500	1.64	195	1/4"	10	1.9	12.70	83.0	<2.5
7803AKC	10563724	13	0.37	500	1.63	200	1/4"	10	1.9	12.70	83.0	<2.5
7803RA	80113673	13	0.37	500	1.64	195	1/4"	10	1.9	12.70	83.0	<2.5
7803RAKC	10563732	13	0.37	500	1.63	200	1/4"	10	1.9	12.70	83.0	<2.5
7802A	80113616	10	0.37	2,000	1.31	163	1/4"	10	1.9	12.70	83.0	2.8/0.7
7802AKC	10563716	10	0.37	2,000	1.35	175	1/4"	10	1.9	12.70	83.0	2.8/0.7
7802RA	80113640	10	0.37	2,000	1.30	163	1/4"	10	1.9	12.70	83.0	2.8/0.7
7802RAKC	80147424	10	0.37	2,000	1.35	175	1/4"	10	1.9	12.70	83.0	2.8/0.7
7807R-A	7807R-A	10	0.25	1,800	1.13	205	1/4"	10	1.5	9.70	87.0	2.49
LA410-EU	01328616	10	0.25	4,500	0.91	228	1/4"	10	1.4	12.80	84.9	2.9/0.7

⁽¹⁾ ISO28927 – 3-axis measurement: vibration level/measurement uncertainty.

Performance at 6.2 bar (90 psi)

Air Drills, Screwdrivers and specialty tools | Screwdrivers

LA439-EU

1/4"  Hexagonal



- 0.25 kW (0.34 HP)
- 1,800 rpm
- Adjustable clutch
- 1-hand forward and reverse switch

LA412-EU

1/4"  Hexagonal



- 0.25 kW (0.34 HP)
- 1,800 rpm
- Positive jaw clutch
- 1-hand forward and reverse switch

371-A

1/4"  Hexagonal







- 0.33 kW (0.44 HP)
- 2,000 rpm
- Positive jaw clutch
- One hand forward/reverse switch

LA413-EU

1/4"  Hexagonal

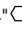
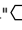

- 0.25 kW (0.34 HP)
- 1,800 rpm
- Adjustable clutch
- 1-hand forward and reverse switch

Part Number	CCN	 in	 kW	 rpm	 kg	 mm	 NPT	 mm	 l/s	 l/s	 dB(A)	 m/s ² /K ⁽¹⁾
LA439-EU	92847805	1/4" 	0.25	1,800	1.10	216	1/4"	10	1.4	13.70	89.9	< 2.5
LA412-EU	01330075	1/4" 	0.25	1,800	1.60	184	1/4"	10	1.9	13.70	89.6	< 2.5
371-A	371-A	1/4" 	0.33	2,000	1.18	186	1/4"	10	1.5	43.00	96.0	1.24
LA413-EU	01330109	1/4" 	0.25	1,800	1.50	260	1/4"	10	1.4	8.00	109.2	< 2.5

⁽¹⁾ ISO28927 – 3-axis measurement: vibration level/measurement uncertainty.

Performance at 6.2 bar (90 psi)

Air Drills, Screwdrivers and specialty tools | Specialty Tools (incl. cutting tools)

326

Heavy duty air cut-Off tool



- 3/8' arbor X 2 7/8' wheel size
- Fast, quiet operation
- Contoured lever throttle with positive self-locking action
- Built-in speed regulator
- 360 degree rotatable chrome-plate spark guard

426

Reversible cut-off tool



- 75 mm (3")
- Only 0.9 kg weight
- Composite housing
- Variable-speed lever
- Rear exhaust directs air away from the operator
- Includes 5 cutting discs

325B

Air nibbler



- Cutting capacity: 1.2 mm (18-gauge, 0.05")
- 4,200 blows per minute
- Variable speed lever

Part Number	CCN	kWatt kW	$\frac{1 \text{ min}}{\text{rpm}}$ rpm	kg	mm	NPT	mm	l/s	l/s	dB(A)	m/s ² /K ⁽¹⁾	Pad Dia/ MM
326	01216514	-	20,000	1.05	226	1/4"	10	4.7	11.80	94.3	-	-
426	47509194001	0.48	20,000	0.90	206	1/4"	10	12.3	-	92.1	4.3	76
325B	46806568	-	4,200	0.95	185	1/4"	10	1.9	8.00	96.0	15.9/19.0	-

⁽¹⁾ ISO28927 – 3-axis measurement: vibration level/measurement uncertainty.

Performance at 6.2 bar (90 psi)

Air Drills, Screwdrivers and specialty tools | Specialty Tools (incl. cutting tools)

429

Heavy duty air reciprocating saw



- Comes with six high-speed steel cutting blades and two hex wrenches
- Cuts flat and curved surfaces
- Durable, long-life tool

529

Reciprocating saw



- Stroke: 10 mm
- 9,500 strokes per minute
- Only 0.54 kg
- Variable speed lever
- 360° adjustable exhaust
- Contains: blades (6 pieces)

4429

Reciprocating saw



- Stroke: 10 mm
- 5,000 strokes per minute
- Variable speed lever
- Piped-away exhaust system

7802SA

Air shear



- Cutting capacity: 1.0 mm (20-gauge, 0.04")
- 4,200 blows per minute

LA415-EU

Air riveter



- Aluminum rivet capacity: 2.4 – 6.35 mm (3/32 – 1/4")
- Stroke: 16 mm

Part Number	CCN	strokes/min	mm	kg	mm	NPT	mm	l/s	l/s	dB(A)	m/s ² /K ⁽¹⁾
429	01365477	10000	10	0.60	209	1/4"	10	3.8	4.25	87.3	25.7/4.0
529	47125885	9,500	10	0.70	246	1/4"	10	0.5	0.53	84.3	3.1/1.6
4429	01371822	5,750	10	0.74	235	1/4"	10	1.9	3.60	66.2	9.5/2.4
7802SA	80113681	4,200	–	1.30	239	1/4"	10	1.9	10.00	83.0	3.0/1.0
LA415-EU	01330141	–	16	2.00	197	1/4"	10	–	2.00	86.8	< 2.5

⁽¹⁾ ISO28927 – 3-axis measurement: vibration level/measurement uncertainty.

Performance at 6.2 bar (90 psi)

LA437-EU

Air riveter









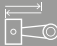

- Aluminum rivet capacity:
2.4 – 4.75 mm (3/32 – 3/16")

LA428-EU

Caulking gun

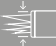

- Power regulator
- Cartridge size: 50 x 215 mm

Part Number	CCN	 mm	 kg	 mm	 NPT	 mm	 l/s	 l/s	 dB(A)	 m/s ² /K ⁽¹⁾
LA437-EU	01328608	16	2.8	164.00	1/4"	10	-	1.80	89.00	3.2/0.7
LA428-EU	01330067	215	1.3	356.00	1/4"	10	-	-	70.00	2.5

⁽¹⁾ ISO28927 – 3-axis measurement: vibration level/measurement uncertainty.

Performance at 6.2 bar (90 psi)

Index

1			
105-C3	51	170	51
105-D2	51	1770	51
105-D3	51		
105-L2	51	2	
1077XPA	51	2015MAX	21
107XPA	51	2025MAX	26
1099XPA	51	2101XPA	20
109XPA	51	2101XPA-QC	20
1105MAX-D2	50	2102XPA	20
1105MAX-D3	50	211	22
115	71	2115PTiMAX-AP	21
116	71	2115Qi	22
116H	71	2115QTiMAX	21
117	71	2115TiMAX-AP	21
119MAX	70	2125PTiMAX	21
1207MAX-D3	50	2125Qi	26
1207MAX-D4	50	2125QTiMAX-AP	21
121/Q-EU	71	212A	22
1211MAX-D3	50	2130AP	27
1211MAX-D4	50	2130AP-2	27
121-EU	71	2130XP-TL	27
123MAX	70	2135PTiMAX-AP	25
125	71	2135Qi	26
131S-EA	28	2135QPTiMAX-AP	25
132	71	2135QTiMAX-AP	25
132U-G	27	2135TiMAX-AP	25
132U-R	27	2141	31
135MAX	70	2145QiMAX-3	31
140EP	65	2145QiMAX-6	31
15QMAX	21	2145QiMAX-AP	31
		2146Q1MAX	30
		2146Q1MAX-3	30
		2146Q1MAX-6	30
		2146Q2MAX	30
		2146Q2MAX	37
		2155QiMAX	36
		2161XP	31
		2161XP-6	31
		216B	23
		2171XP	37
		2171XP-6	37
		2175MAX	38
		2175MAX-6	38
		222A	22
		2235PTiMAX	25
		2235QPTiMAX	25
		2235QTiMAX	25
		2235QTiMAX-2	25
		2235TiMAX	25
		2235TiMAX-2	25
		2236QPTiMAX	24
		2236QTiMAX	24
		2236QTiMAX-2	24
		231C-AP	27
		231HA	27
		231HA-2	27
		232TGSL	29
		236	29
		244A	29
		244A-2	29
		259	32

261	32	312A	64	4152	61
261-3	32	313-B	62	4152-HL	61
261-6	32	314-B	62	4152-HL-SR	61
271	37	315-EU	64	426	77
280	35	317-B	62	429	78
280-6	35	318-B	62	4429	78
280-S-6	35	319-B	62	444	57
2850MAX	34	320PG	65	4445	57
2850MAX-6	34	325B	77	445	57
285B	35	326	77		
285B-6	35	327-A	64	5	
285B-6-AP	35	327LS-A	64	5102MAX	54
285B-S6	35	3445MAX	57	5102MAX-M	54
290	38	3445MAX-M	57	5104MAX	54
290-6	38	344MAX	57	5104MAX-M	54
295A	38	345MAX	57	5106MAX	54
295A-6	38	345MAX-M	57	5106MAX-M	54
		35MAX	25	5107MAX	54
3		360-313	65	5107MAX-M	54
301B	56	360-418	65	5108MAX	54
301B-M	56	36MAX	25	5108MAX-M	54
302B	55	36QMAX	25	5151-5	60
302B-M	55	371-A	76	5151-5-HL	60
307B	55			5151-6	60
307B-M	55	4		5151-6-HL	60
308B	55	409	56	5152-5	60
308B-M	55	4151	61	5152-5-HL	60
3103XPA	63	4151-2	61	5152-6	60
311A	61	4151-5	61	5152-6-HL	60
3128XPA	63	4151-HL	61	5208MAX	54
3129XPA	63	4151-HL-2	61	5208MAX-M	54

529	78	C	LA429-EU	56	
5445MAX	57	C5101	14	LA437-EU	79
5445MAX-M	57			LA439-EU	76
545MAX	57	D	LUB5130	14	
545MAX-M	57	D1131	12		
		D3141	12	R	
6		D3411	12	R3130	11
631L	35	D5241	12	R3150	11
631S	35			R5330	11
		E		R5350	11
7		E131	28		
7802A	75	E132	28	W	
7802AKC	75	E688-8	36	W3111	7
7802RA	75	E699-8	36	W3131	7
7802RAKC	75			W3151	7
7802SA	78	G		W5133	8
7803A	75	G4621	13	W5133P-C1D2	8
7803AKC	75	G4911	13	W5143P-C1D2	8
7803RA	75	G5351M	13	W5153	8
7803RAKC	75			W7152	9
7804R	74	H		W7152P	9
7807R-A	75	H3111	14	W7153-AP	6
				W7172	9
B		L		W7252	9
BL1204	15	LA158	23	W8171	10
BL2012	15	LA410-EU	75	W8191	10
BL2022	15	LA412-EU	76	W8571	10
BL1124	15	LA413-EU	76	W8591	10
BC1221	15	LA415-EU	78	W9491	10
BC1121	15	LA421B-EU	57	W9691	10
		LA422B-EU	57	z	
		LA428-EU	79		



Ingersoll Rand Inc. (NYSE:IR), driven by an entrepreneurial spirit and ownership mindset, is dedicated to Making Life Better for our employees, customers, shareholders, and planet. Customers lean on us for exceptional performance and durability in mission-critical flow creation and industrial solutions. Supported by over 80+ respected brands, our products and services excel in the most complex and harsh conditions. Our employees develop customers for life through their daily commitment to expertise, productivity, and efficiency. For more information, visit www.IRCO.com.